



TOWN OF CANMORE
ENGINEERING SERVICES

CAP 7301

2023 BUS STOP IMPROVEMENT PROGRAM

TOWN OF CANMORE

ISSUED FOR TENDER

WSP Project No: 231-01538-00

Date: 2023-07-24

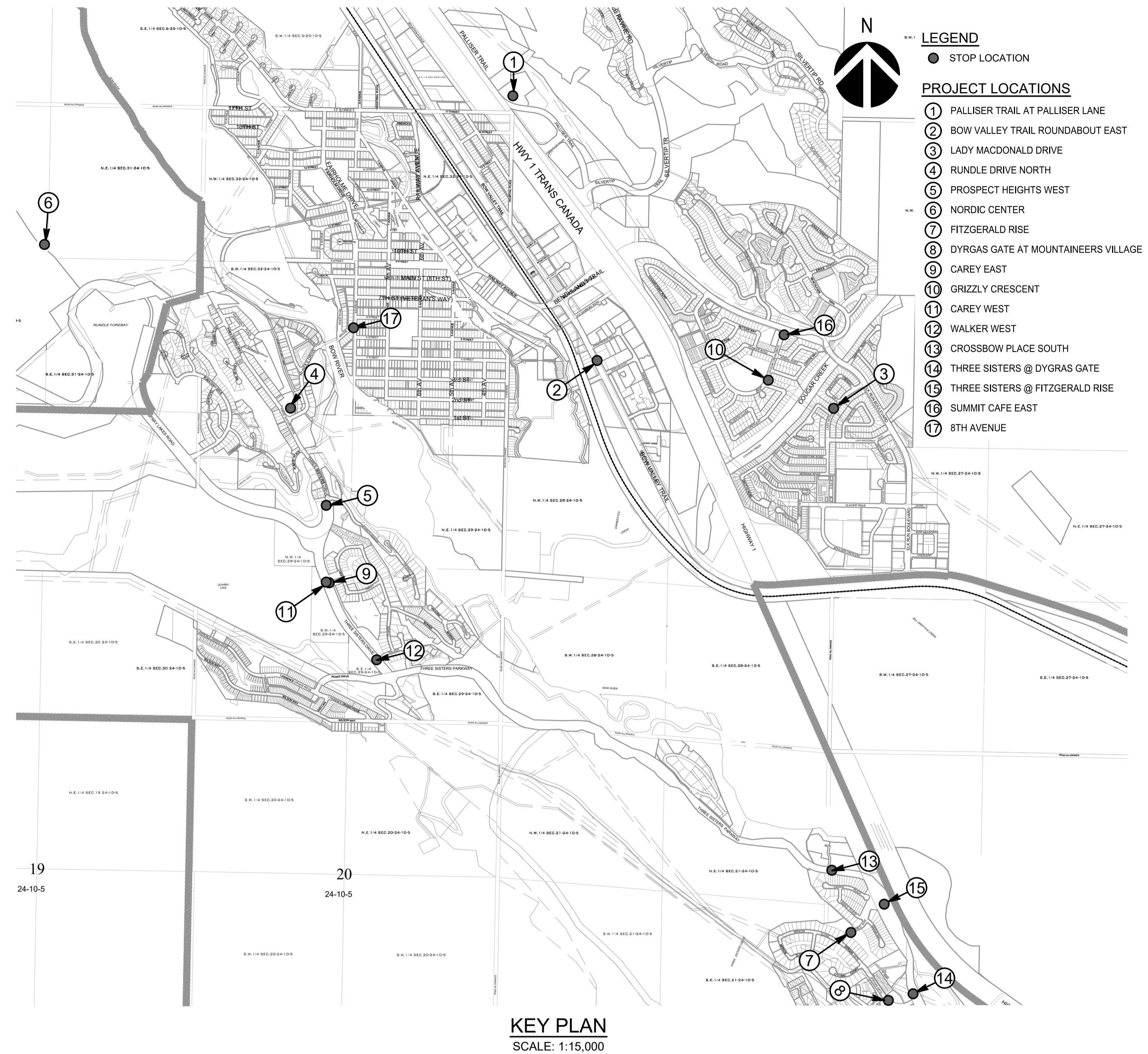

DRAWING INDEX	
Sheet Number	Sheet Title
--	COVER
C01	TST94 - PALLISER TRAIL AT PALLISER LANE
C02	TST94 - BOW VALLEY TRAIL ROUNDABOUT EAST
C03	TST22 - LADY MACDONALD CRESCENT
C04	TST44 - RUNDLE DRIVE NORTH
C05	TST45 - PROSPECT HEIGHTS WEST
C06	TST80 - NORDIC CENTRE
C07	TST48 - FITZGERALD RISE
C08	TST20 - DYRGAS GATE AT MOUNTAINEERS VILLAGE

C09	TST28 - CAREY EAST
C10	TST39 - GRIZZLY CRESCENT
C11	TST46 - CAREY WEST
C12	TST47 - WALKER WEST
C13	TST64 - CROSSBOW PLACE SOUTH
C14	TST65 - THREE SISTERS AT DYRGAS GATE
C15	TST77 - THREE SISTERS AT FITZGERALD RISE
C16	TST26 - SUMMIT CAFE EAST
C17	TST76 - 8TH AVENUE
C1000	TYPICAL DETAILS
C1001	TYPICAL DETAILS
C1002	TYPICAL DETAILS

We see the future more clearly and design for it today.



NOTE: DESIGNS HAVE BEEN BASED ON LIDAR DATA AND ORTHOPHOTO. LAYOUT TO BE REVIEWED ONSITE WITH ENGINEER AND TOWN OF CANMORE REPRESENTATIVE.

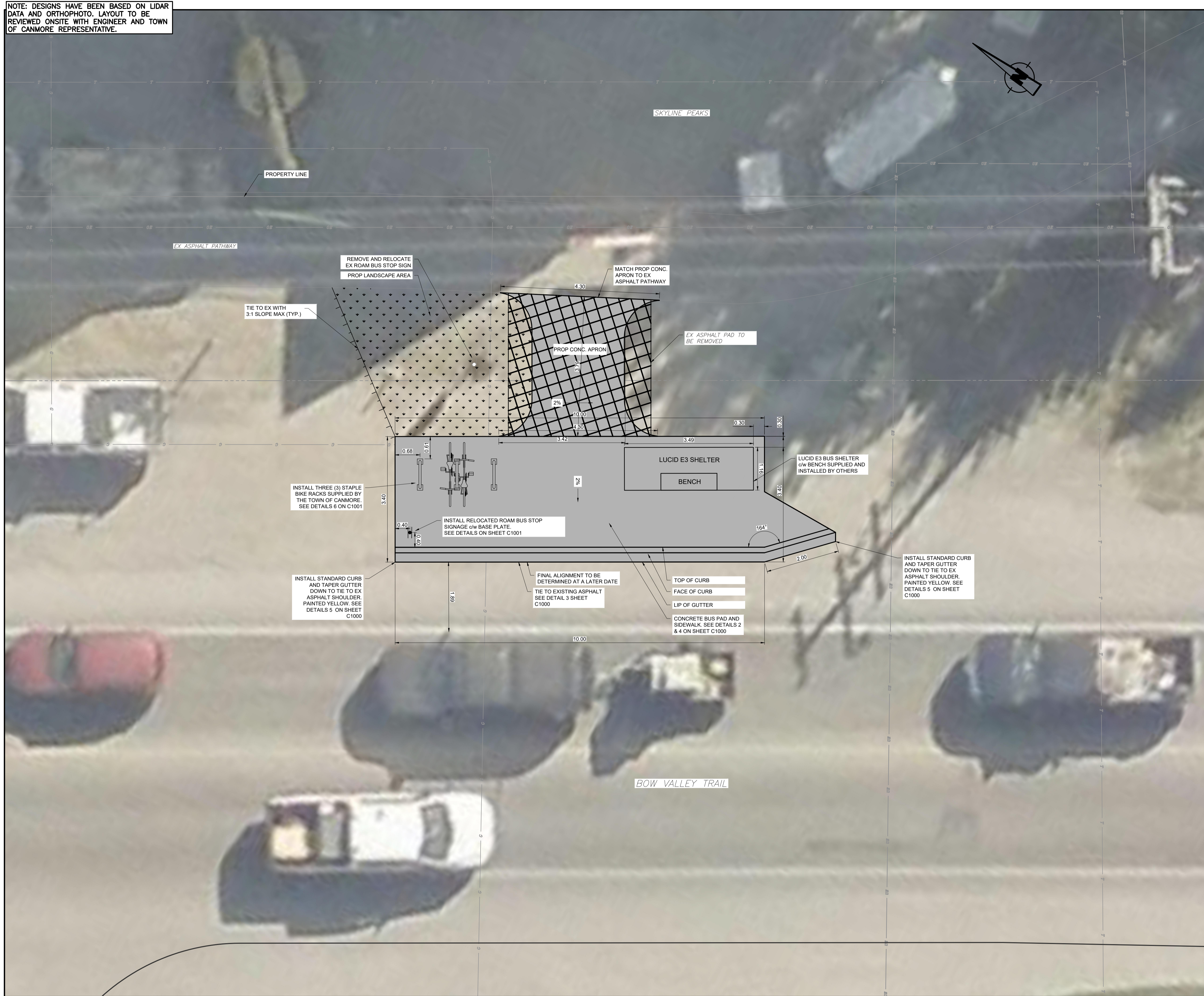

LEGEND

- PROPERTY LINE (EX.)
- TOP OF SLOPE (EX.)
- TOP OF SLOPE (PR.)
- BOTTOM OF SLOPE (EX.)
- BOTTOM OF SLOPE (PR.)
- OVERHEAD UTILITY (EX.)
- WATERMAIN (EX.)
- SANITARY SEWER (EX.)
- STORM DITCH (EX.)
- STORM SEWER (EX.)
- LOW PRESSURE GAS LINE (EX.)
- HIGH PRESSURE GAS LINE (EX.)
- UNDERGROUND POWER (EX.)
- UNDERGROUND COMM. (EX.)
- MAJOR CONTOUR (EX.)
- MINOR CONTOUR (EX.)
- WOOD FENCE (EX.)
- SIGN (EX.)
- SIGN (PR.)
- SOLAR BOLLARD (PR.)
- SPOT ELEVATION (EX.)
- SPOT ELEVATION (PR.)

- GRAVEL PAD (PR.)
- ASPHALT PATHWAY (PR.)
- CONCRETE BUS PAD/SIDEWALK (PR.)
- GRASS (PR.)
- CONCRETE (EX.)
- ASPHALT REMOVAL

- ### NOTES
1. ALL WORK SHALL BE PERFORMED IN ACCORDANCE WITH THE TOWN OF CANMORE'S CURB AND GUTTER DESIGN AND CONSTRUCTION GUIDELINES.
 2. EXCAVATION PERMITS AND ROAD USE/CLOSURE PERMITS WILL BE REQUIRED FROM THE TOWN OF CANMORE FOR ALL WORK WITHIN THE TOWN RIGHT-OF-WAY. THE CONTRACTOR IS RESPONSIBLE FOR NOTIFYING, MAINTAINING, AND COORDINATING ACCESS FOR AFFECTED RESIDENTS.
 3. CONTRACTOR IS RESPONSIBLE FOR OBTAINING ALL NECESSARY APPROVALS FROM MUNICIPAL AND PROVINCIAL JURISDICTIONS PRIOR TO CONSTRUCTION INCLUDING EROSION CONTROL.
 4. THE LOCATION OF ALL EXISTING INFRASTRUCTURE (HORIZONTAL & VERTICAL) TO BE CONFIRMED BY THE CONTRACTOR IN THE FIELD BEFORE CONSTRUCTION BEGINS.
 5. EXISTING GRADES TO BE MAINTAINED.
 6. ALL DISTANCES AND ELEVATION ARE IN METRES UNLESS OTHERWISE NOTED.
 7. ALL TREES WITHIN GRADING LIMITS TO BE REMOVED.
 8. ALIGNMENT MAY BE SUBJECT TO CHANGE.

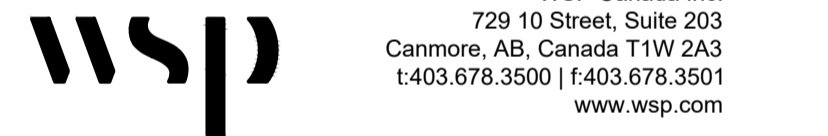

PERMIT TO PRACTICE
WSP CANADA INC.

RIM SIGNATURE: *[Signature]*
RIM APEGA ID #: 46733
DATE: July 26 2023

PERMIT NUMBER: P007641
The Association of Professional Engineers and Geoscientists of Alberta (APEGA)

PERMIT: _____ ENGINEER: _____

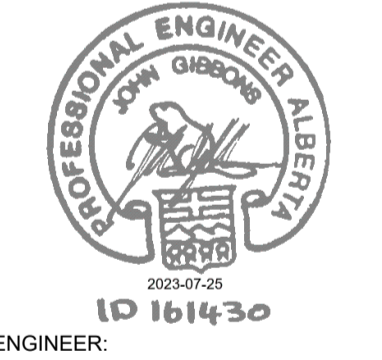

APPROVED: _____ DATE: 2023-06-27

DRAWN: AI SCALE: **HORZ: 1: 50**

MANAGER OF ENGINEERING: _____

REV	YYYY	MM	DD	DESCRIPTION	DPS	CHK	ENG
3	2023	07	24	ISSUED FOR TENDER	JA	JW	JG
2	2023	07	07	ISSUED FOR TOWN APPROVAL	JA	LC	JG
1	2023	06	02	ISSUED FOR TOWN APPROVAL	AI	LC	JG

CONSULTANT: WSP Canada Inc. CONSULTANT FILE NUMBER: 231-01538-00



CAP 7301
TST93 - BOW VALLEY TRAIL ROUNDABOUT EAST

SHEET NO: C02 TOWN FILE NO: -

PLAN – BUS STOP TST93 – BOW VALLEY TRAIL ROUNDABOUT EAST
1:50

Last Saved: 2023-07-26 12:45:12 PM. By: Arno, Jesse. File: B:\wsp\cwg\Bask and Gray\B...
 P:\2023\231-01538-00\Bask and Gray\general engineering\rev\cwg\technical\05_04_24_cwg2_Production\2023_Bus Stop\Approved\Bask and Gray\TST93 - BOW VALLEY TRAIL ROUNDABOUT EAST.dwg



NOTE: DESIGNS HAVE BEEN BASED ON LIDAR DATA AND ORTHOPHOTO. LAYOUT TO BE REVIEWED ONSITE WITH ENGINEER AND TOWN OF CANMORE REPRESENTATIVE.

LEGEND

	PROPERTY LINE (EX.)
	TOP OF SLOPE (EX.)
	TOP OF SLOPE (PR.)
	BOTTOM OF SLOPE (EX.)
	BOTTOM OF SLOPE (PR.)
	OVERHEAD UTILITY (EX.)
	WATERMAIN (EX.)
	SANITARY SEWER (EX.)
	STORM DITCH (EX.)
	STORM SEWER (EX.)
	LOW PRESSURE GAS LINE (EX.)
	HIGH PRESSURE GAS LINE (EX.)
	UNDERGROUND POWER (EX.)
	UNDERGROUND COMM. (EX.)
	MAJOR CONTOUR (EX.)
	MINOR CONTOUR (EX.)
	WOOD FENCE (EX.)
	SIGN (EX.)
	SIGN (PR.)
	SOLAR BOLLARD (PR.)
	SPOT ELEVATION (EX.)
	SPOT ELEVATION (PR.)
	GRAVEL PAD (PR.)
	ASPHALT PATHWAY (PR.)
	CONCRETE BUS PAD/SIDEWALK (PR.)
	GRASS (PR.)
	CONCRETE (EX.)
	ASPHALT REMOVAL

- NOTES**
1. ALL WORK SHALL BE PERFORMED IN ACCORDANCE WITH THE TOWN OF CANMORE'S CURRENT ENGINEERING DESIGN AND CONSTRUCTION GUIDELINES.
 2. EXCAVATION PERMITS AND ROAD USE/CLOSURE PERMITS WILL BE REQUIRED FROM THE TOWN OF CANMORE FOR ALL WORK WITHIN THE TOWN RIGHT-OF-WAY. THE CONTRACTOR IS RESPONSIBLE FOR NOTIFYING, MAINTAINING, AND COORDINATING ACCESS FOR AFFECTED RESIDENTS.
 3. CONTRACTOR IS RESPONSIBLE FOR OBTAINING ALL NECESSARY APPROVALS FROM MUNICIPAL AND PROVINCIAL JURISDICTIONS PRIOR TO CONSTRUCTION INCLUDING EROSION CONTROL.
 4. THE LOCATION OF ALL EXISTING INFRASTRUCTURE (HORIZONTAL & VERTICAL) TO BE CONFIRMED BY THE CONTRACTOR IN THE FIELD BEFORE CONSTRUCTION BEGINS.
 5. EXISTING GRADES TO BE MAINTAINED.
 6. ALL DISTANCES AND ELEVATIONS ARE IN METRES UNLESS OTHERWISE NOTED.
 7. ALL TREES WITHIN GRADING LIMITS TO BE REMOVED.
 8. ANY LANDSCAPE REHABILITATION WILL REQUIRE SOD.
 9. NON PERMEABLE BARRIER IS REQUIRED. SEE DETAIL 1 ON SHEET C1000.

wsp WSP Canada Inc.
729 10 Street, Suite 203
Canmore, AB, Canada T1W 2A3
t:403.678.3500 | f:403.678.3501
www.wsp.com

PERMIT TO PRACTICE
WSP CANADA INC.

RM SIGNATURE:
RM APEGA ID #: 46733
DATE: July 26 2023

PERMIT NUMBER: P007641
The Association of Professional Engineers and Geoscientists of Alberta (APEGA)

2023-07-26
ID 161430

PERMIT:

APPROVED:	DRAWN:	DATE:
AI		2023-06-27

MANAGER OF ENGINEERING: _____

ENGINEER: _____

SCALE: **HORZ: 1: 50**

9							
8							
7							
6							
5							
4							
3	2023	07	24	ISSUED FOR TENDER	JA	JW	JG
2	2023	07	07	ISSUED FOR TOWN APPROVAL	JA	JW	JG
1	2023	06	02	ISSUED FOR TOWN APPROVAL	AI	JW	JG
REV	YYYY	MM	DD	DESCRIPTION	DPS	CHK	ENG

CONSULTANT: WSP Canada Inc. CONSULTANT FILE NUMBER: 231-01538-00

Town of **CANMORE** **Town of Canmore ENGINEERING SERVICES**
CAP 7301

TST44 - RUNDLE DRIVE NORTH

SHEET NO:	C04	TOWN FILE NO:	-
-----------	-----	---------------	---

Label Saved: 2023-07-26 12:47:11 PM. By: Anna, Jesse. Pwd: S3k4C4c. Bk: and Gray.dwg. PLOT: 20230726 12:58:00. For general engineering information only.

PLAN – BUS STOP TST44 – RUNDLE DRIVE NORTH
1:50

NOTE: DESIGNS HAVE BEEN BASED ON LIDAR DATA AND ORTHOPHOTO. LAYOUT TO BE REVIEWED ONSITE WITH ENGINEER AND TOWN OF CANMORE REPRESENTATIVE.

PROVINCIAL LANDS

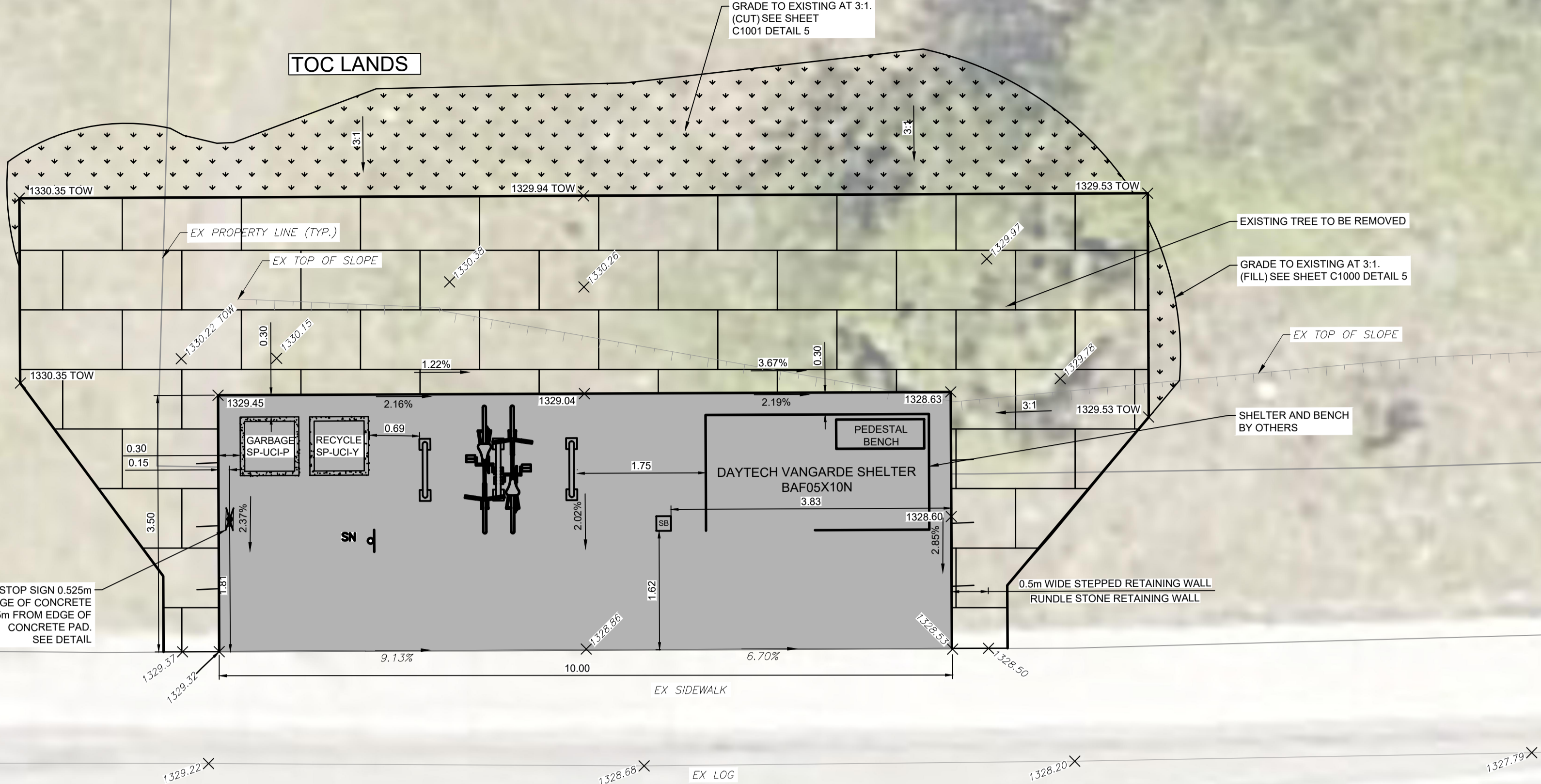

LEGEND

- PROPERTY LINE (EX.)
- TOP OF SLOPE (EX.)
- TOP OF SLOPE (PR.)
- BOTTOM OF SLOPE (EX.)
- BOTTOM OF SLOPE (PR.)
- OVERHEAD UTILITY (EX.)
- WATERMAIN (EX.)
- SANITARY SEWER (EX.)
- STORM SEWER (EX.)
- LOW PRESSURE GAS LINE (EX.)
- HIGH PRESSURE GAS LINE (EX.)
- UNDERGROUND POWER (EX.)
- UNDERGROUND COMM. (EX.)
- MAJOR CONTOUR (EX.)
- MINOR CONTOUR (EX.)
- WOOD FENCE (EX.)
- SIGN (EX.)
- SIGN (PR.)
- SOLAR BOLLARD (PR.)
- SPOT ELEVATION (EX.)
- SPOT ELEVATION (PR.)
- GRAVEL PAD (PR.)
- CONCRETE BUS PAD/SIDEWALK (PR.)
- GRASS (PR.)
- CONCRETE (EX.)
- CONCRETE BLOCK RETAINING WALL

NOTES

- ALL WORK SHALL BE PERFORMED IN ACCORDANCE WITH THE TOWN OF CANMORE'S CURRENT ENGINEERING DESIGN AND CONSTRUCTION GUIDELINES.
- EXCAVATION PERMITS AND ROAD USE/CLOSURE PERMITS WILL BE REQUIRED FROM THE TOWN OF CANMORE FOR ALL WORK WITHIN THE TOWN RIGHT-OF-WAY. THE CONTRACTOR IS RESPONSIBLE FOR NOTIFYING, MAINTAINING, AND COORDINATING ACCESS FOR AFFECTED RESIDENTS.
- CONTRACTOR IS RESPONSIBLE FOR OBTAINING ALL NECESSARY APPROVALS FROM MUNICIPAL AND PROVINCIAL JURISDICTIONS PRIOR TO CONSTRUCTION INCLUDING EROSION CONTROL.
- THE LOCATION OF ALL EXISTING INFRASTRUCTURE (HORIZONTAL & VERTICAL) TO BE CONFIRMED BY THE CONTRACTOR IN THE FIELD BEFORE CONSTRUCTION BEGINS.
- EXISTING GRADES TO BE MAINTAINED.
- ALL DISTANCES AND ELEVATION ARE IN METRES UNLESS OTHERWISE NOTED.
- ALL TREES WITHIN GRADING LIMITS TO BE REMOVED.

THREE SISTERS DRIVE

wsp

WSP Canada Inc.
729 10 Street, Suite 203
Canmore, AB, Canada T1W 2A3
t:403.678.3500 | f:403.678.3501
www.wsp.com

PERMIT TO PRACTICE
WSP CANADA INC.

RIM SIGNATURE: [Signature]
RIM APEGA ID #: 46733
DATE: July 26 2023
PERMIT NUMBER: P007641
The Association of Professional Engineers and Geoscientists of Alberta (APEGA)

PERMIT: _____ ENGINEER: _____

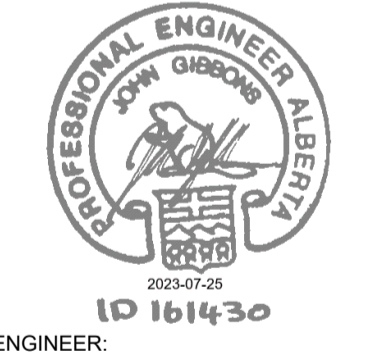

APPROVED: _____ DRAWN: AI DATE: 2023-06-27
SCALE: **HORZ: 1:50**

TOWN OF CANMORE

9											
8											
7											
6											
5											
4											
3	2023	07	24	ISSUED FOR TENDER		JA	JW	JG			
2	2023	07	07	ISSUED FOR TOWN APPROVAL		JA	JW	JG			
1	2023	06	02	ISSUED FOR TOWN APPROVAL		AI	JW	JG			
REV	YYYY	MM	DD	DESCRIPTION		DPS	CHK	ENG			

CONSULTANT: WSP Canada Inc. CONSULTANT FILE NUMBER: 231-01538-00

Town of Canmore
ENGINEERING SERVICES

CAP 7301
TST45 - PROSPECT HEIGHTS WEST

Last Saved 2023-07-24 4:48:20 PM By: Alaina, Jesse Prod Style: C:\C:\C:\C:\C\Blast and Gray.rvt
 P:\2023\2023-07-24 4:48:20 PM By: Alaina, Jesse Prod Style: C:\C:\C\Blast and Gray.rvt
 P:\2023\2023-07-24 4:48:20 PM By: Alaina, Jesse Prod Style: C:\C\Blast and Gray.rvt

NOTE: DESIGNS HAVE BEEN BASED ON LIDAR DATA AND ORTHOPHOTO. LAYOUT TO BE REVIEWED ONSITE WITH ENGINEER AND TOWN OF CANMORE REPRESENTATIVE.

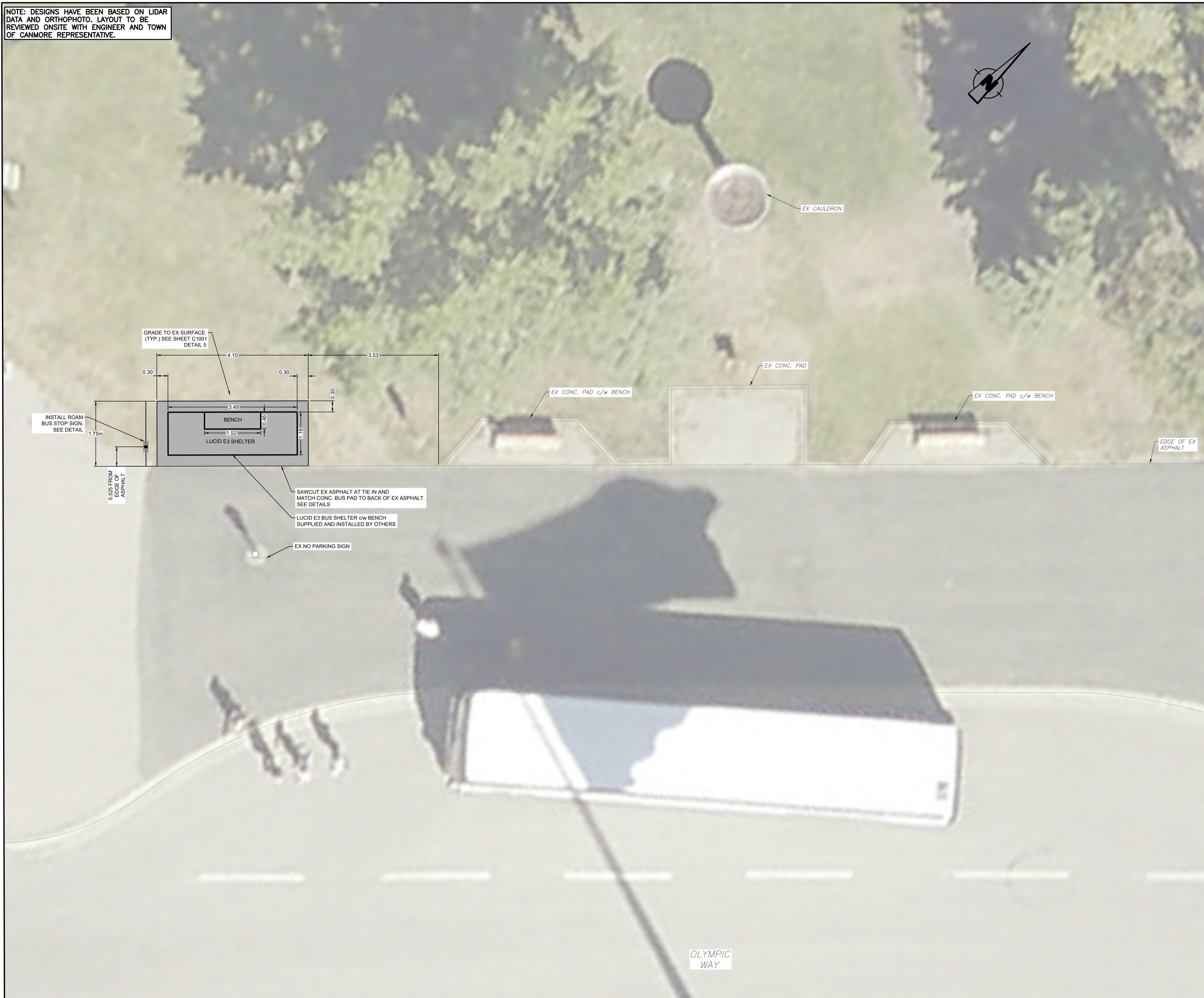

LEGEND

	PROPERTY LINE (EX.)
	TOP OF SLOPE (EX.)
	TOP OF SLOPE (PR.)
	BOTTOM OF SLOPE (EX.)
	BOTTOM OF SLOPE (PR.)
	OVERHEAD UTILITY (EX.)
	WATERMAIN (EX.)
	SANITARY SEWER (EX.)
	STORM DITCH (EX.)
	STORM SEWER (EX.)
	LOW PRESSURE GAS LINE (EX.)
	HIGH PRESSURE GAS LINE (EX.)
	UNDERGROUND POWER (EX.)
	UNDERGROUND COMM. (EX.)
	MAJOR CONTOUR (EX.)
	MINOR CONTOUR (EX.)
	WOOD FENCE (EX.)
	SIGN (EX.)
	SIGN (PR.)
	SOLAR BOLLARD (PR.)
	SPOT ELEVATION (EX.)
	SPOT ELEVATION (PR.)
	GRAVEL PAD (PR.)
	ASPHALT PATHWAY (PR.)
	CONCRETE BUS PAD/ SIDEWALK (PR.)
	GRASS (PR.)
	CONCRETE (EX.)
	ASPHALT REMOVAL

- NOTES**
- ALL WORK SHALL BE PERFORMED IN ACCORDANCE WITH THE TOWN OF CANMORE'S CURRENT ENGINEERING DESIGN AND CONSTRUCTION GUIDELINES.
 - EXCAVATION PERMITS AND ROAD USE CLOSURE PERMITS WILL BE REQUIRED FROM THE TOWN OF CANMORE FOR ALL WORK WITHIN THE TOWN RIGHT-OF-WAY. THE CONTRACTOR IS RESPONSIBLE FOR NOTIFYING, MAINTAINING, AND COORDINATING ACCESS FOR AFFECTED RESIDENTS.
 - CONTRACTOR IS RESPONSIBLE FOR OBTAINING ALL NECESSARY APPROVALS FROM MUNICIPAL AND PROVINCIAL JURISDICTIONS PRIOR TO CONSTRUCTION INCLUDING EROSION CONTROL.
 - THE LOCATION OF ALL EXISTING INFRASTRUCTURE (HORIZONTAL & VERTICAL) TO BE CONFIRMED BY THE CONTRACTOR IN THE FIELD BEFORE CONSTRUCTION BEGINS.
 - EXISTING GRADES TO BE MAINTAINED.
 - ALL DISTANCES AND ELEVATION ARE IN METRES UNLESS OTHERWISE NOTED.
 - ALL TREES WITHIN GRADING LIMITS TO BE REMOVED.
 - ANY LANDSCAPE REHABILITATION WILL REQUIRE SOD.

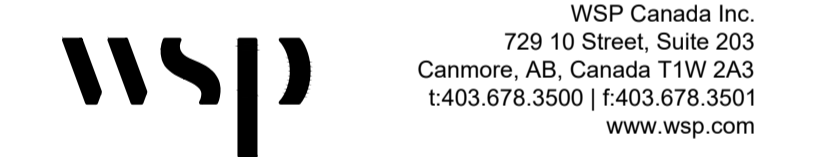

**PERMIT TO PRACTICE
WSP CANADA INC.**

RIM SIGNATURE:

RIM APEGA ID #: 46733

DATE: July 26 2023

PERMIT NUMBER: P007641

The Association of Professional Engineers and Geoscientists of Alberta (APEGA)

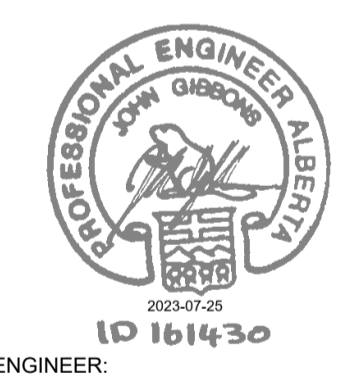

PERMIT: _____ ENGINEER: _____

APPROVED: _____ DRAWN: AI DATE: 2023-06-27

MANAGER OF ENGINEERING: _____ SCALE: **HORZ: 1:50**

TOWN OF CANMORE:

9					
8					
7					
6					
5					
4					
3	2023	07	24	ISSUED FOR TENDER	JA JW JG
2	2023	07	07	ISSUED FOR TOWN APPROVAL	JA JW JG
1	2023	06	02	ISSUED FOR TOWN APPROVAL	AI JW JG
REV	YYYY	MM	DD	DESCRIPTION	DPS CHK ENG

CONSULTANT: WSP Canada Inc. CONSULTANT FILE NUMBER: 231-01538-00



CAP 7301

TST80 - NORDIC CENTRE

SHEET NO: C06 TOWN FILE NO: -

PLAN – BUS STOP TST80 – NORDIC CENTRE
1:50

Last Saved: 2023-07-26 12:40:04 PM. By: Arno, Jesse. File: B:\wsp\CAD\Black and Grey\23_2023\23-01538-00_150\General Engineering Services\Town of Canmore\2023 Bus Stop\Approved\BareBalls\5 Stop\T80 - Nordic Centre.dwg. 14 CAD\2_2023\Production\2023 Bus Stop\Approved\BareBalls\5 Stop\T80 - Nordic Centre.dwg. 2023-07-26

NOTE: DESIGNS HAVE BEEN BASED ON LIDAR DATA AND ORTHOPHOTO. LAYOUT TO BE REVIEWED ONSITE WITH ENGINEER AND TOWN OF CANMORE REPRESENTATIVE.



LEGEND	
	PROPERTY LINE (EX.)
	TOP OF SLOPE (EX.)
	TOP OF SLOPE (PR.)
	BOTTOM OF SLOPE (EX.)
	BOTTOM OF SLOPE (PR.)
	OVERHEAD UTILITY (EX.)
	WATERMAIN (EX.)
	SANITARY SEWER (EX.)
	STORM DITCH (EX.)
	STORM SEWER (EX.)
	LOW PRESSURE GAS LINE (EX.)
	HIGH PRESSURE GAS LINE (EX.)
	UNDERGROUND POWER (EX.)
	UNDERGROUND COMM. (EX.)
	MAJOR CONTOUR (EX.)
	MINOR CONTOUR (EX.)
	WOOD FENCE (EX.)
	SIGN (EX.)
	SIGN (PR.)
	SOLAR BOLLARD (PR.)
	SPOT ELEVATION (EX.)
	SPOT ELEVATION (PR.)
	GRAVEL PAD (PR.)
	ASPHALT PATHWAY (PR.)
	CONCRETE BUS PAD/ SIDEWALK (PR.)
	GRASS (PR.)
	CONCRETE (EX.)
	ASPHALT REMOVAL

- NOTES**
1. ALL WORK SHALL BE PERFORMED IN ACCORDANCE WITH THE TOWN OF CANMORE'S CURRENT ENGINEERING DESIGN AND CONSTRUCTION GUIDELINES.
 2. EXCAVATION PERMITS AND ROAD USE/CLOSURE PERMITS WILL BE REQUIRED FROM THE TOWN OF CANMORE FOR ALL WORK WITHIN THE TOWN RIGHT-OF-WAY. THE CONTRACTOR IS RESPONSIBLE FOR NOTIFYING, MAINTAINING, AND COORDINATING ACCESS FOR AFFECTED RESIDENTS.
 3. CONTRACTOR IS RESPONSIBLE FOR OBTAINING ALL NECESSARY APPROVALS FROM MUNICIPAL AND PROVINCIAL JURISDICTIONS PRIOR TO CONSTRUCTION INCLUDING EROSION CONTROL.
 4. THE LOCATION OF ALL EXISTING INFRASTRUCTURE (HORIZONTAL & VERTICAL) TO BE CONFIRMED BY THE CONTRACTOR IN THE FIELD BEFORE CONSTRUCTION BEGINS.
 5. EXISTING GRADES TO BE MAINTAINED.
 6. ALL DISTANCES AND ELEVATIONS ARE IN METRES UNLESS OTHERWISE NOTED.
 7. ALL TREES WITHIN GRADING LIMITS TO BE REMOVED.

wsp
 WSP Canada Inc.
 729 10 Street, Suite 203
 Canmore, AB, Canada T1W 2A3
 t:403.678.3500 | f:403.678.3501
 www.wsp.com

PERMIT TO PRACTICE
WSP CANADA INC.
 RM SIGNATURE: *[Signature]*
 RM APEGA ID #: 46733
 DATE: July 26 2023
PERMIT NUMBER: P007641
 The Association of Professional Engineers and Geoscientists of Alberta (APEGA)

PROFESSIONAL ENGINEER ALBERTA
 10 161430
 2023-07-25
 ENGINEER:

PERMIT: _____ APPROVED: _____ DRAWN: AI DATE: 2023-06-27
 SCALE: **HORZ: 1: 50**
 MANAGER OF ENGINEERING: _____
 TOWN OF CANMORE:

REV	YYYY	MM	DD	DESCRIPTION	DPS	CHK	ENG
3	2023	07	24	ISSUED FOR TENDER	JA	JW	JG
2	2023	07	07	ISSUED FOR TOWN APPROVAL	JA	JW	JG
1	2023	06	02	ISSUED FOR TOWN APPROVAL	AI	JW	JG

CONSULTANT: WSP Canada Inc. CONSULTANT FILE NUMBER: 231-01538-00

Town of **CANMORE** **ENGINEERING SERVICES**
 CAP 7301

TST48 - FITZGERALD RISE

PLAN – BUS STOP TST48 – FITZGERALD RISE
 1:50

Label Saved: 2023-07-24 11:37:37 AM. By: Anuro, Jesse. Proj: Baf05x10n Bus Shelter. Location: 2023 Bus Shelter. Project: 2023 Bus Shelter. Drawing: FITZGERALD RISE. File: P:\2023\231-01538-00\general\engineering\20230724\231-01538-00-01.dwg

NOTE: DESIGNS HAVE BEEN BASED ON LIDAR DATA AND ORTHOPHOTO. LAYOUT TO BE REVIEWED ONSITE WITH ENGINEER AND TOWN OF CANMORE REPRESENTATIVE.

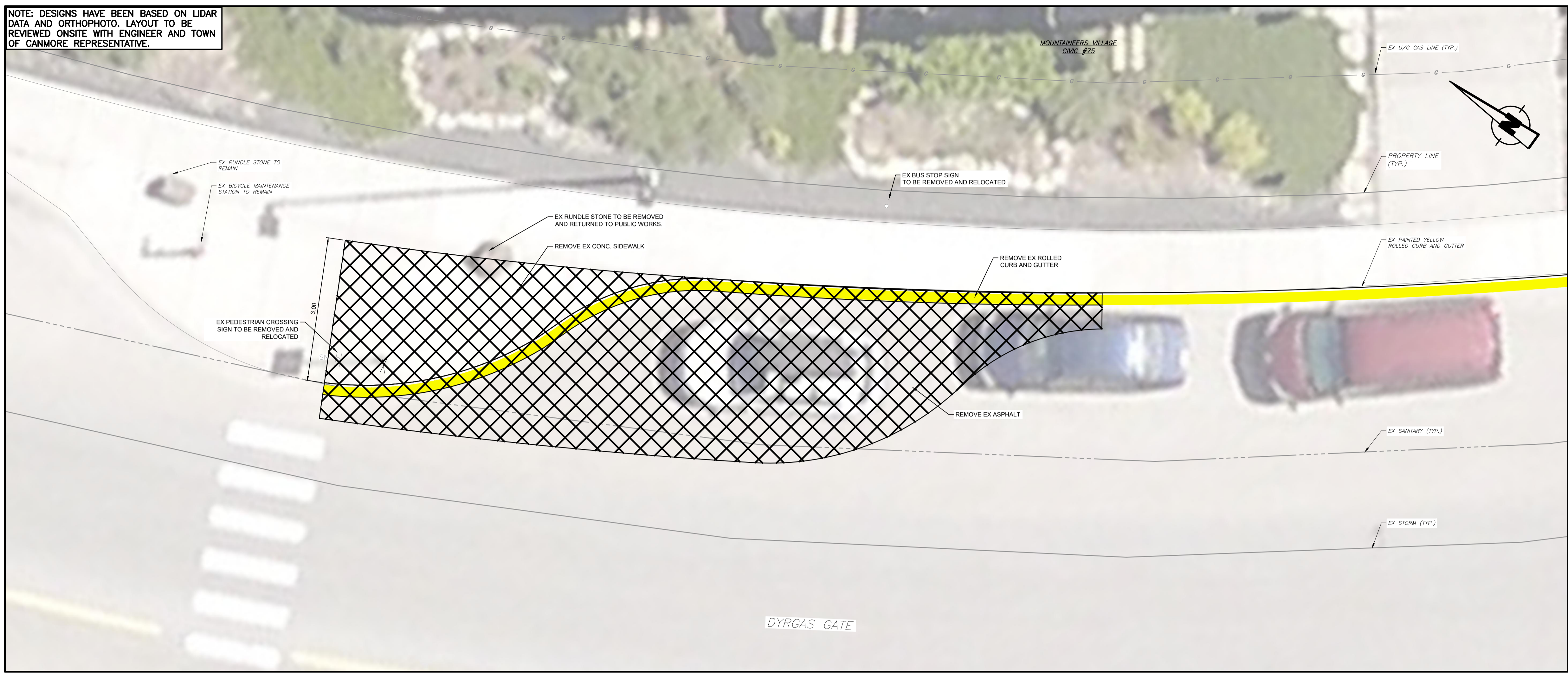

LEGEND

- PROPERTY LINE (EX.)
- TOP OF SLOPE (EX.)
- TOP OF SLOPE (PR.)
- BOTTOM OF SLOPE (EX.)
- BOTTOM OF SLOPE (PR.)
- OVERHEAD UTILITY (EX.)
- WATERMAIN (EX.)
- SANITARY SEWER (EX.)
- STORM DITCH (EX.)
- STORM SEWER (EX.)
- LOW PRESSURE GAS LINE (EX.)
- HIGH PRESSURE GAS LINE (EX.)
- UNDERGROUND POWER (EX.)
- UNDERGROUND COMM. (EX.)
- MAJOR CONTOUR (EX.)
- MINOR CONTOUR (EX.)
- WOOD FENCE (EX.)
- SIGN (EX.)
- SIGN (PR.)
- SOLAR BOLLARD (PR.)
- SPOT ELEVATION (EX.)
- SPOT ELEVATION (PR.)
- GRAVEL PAD (PR.)
- ASPHALT PATHWAY (PR.)
- CONCRETE BUS PAD/SIDEWALK (PR.)
- GRASS (PR.)
- CONCRETE (EX.)
- ASPHALT REMOVAL

NOTES

1. ALL WORK SHALL BE PERFORMED IN ACCORDANCE WITH THE TOWN OF CANMORE'S CURRENT ENGINEERING DESIGN AND CONSTRUCTION GUIDELINES.
2. EXCAVATION PERMITS AND ROAD USE/CLOSURE PERMITS WILL BE REQUIRED FROM THE TOWN OF CANMORE FOR ALL WORK WITHIN THE TOWN RIGHT-OF-WAY. THE CONTRACTOR IS RESPONSIBLE FOR NOTIFYING, MAINTAINING, AND COORDINATING ACCESS FOR AFFECTED RESIDENTS.
3. CONTRACTOR IS RESPONSIBLE FOR OBTAINING ALL NECESSARY APPROVALS FROM MUNICIPAL AND PROVINCIAL JURISDICTIONS PRIOR TO CONSTRUCTION INCLUDING EROSION CONTROL.
4. THE LOCATION OF ALL EXISTING INFRASTRUCTURE (HORIZONTAL & VERTICAL) TO BE CONFIRMED BY THE CONTRACTOR IN THE FIELD BEFORE CONSTRUCTION BEGINS.
5. EXISTING GRADES TO BE MAINTAINED.
6. ALL DISTANCES AND ELEVATION ARE IN METRES UNLESS OTHERWISE NOTED.
7. ALL TREES WITHIN GRADING LIMITS TO BE REMOVED

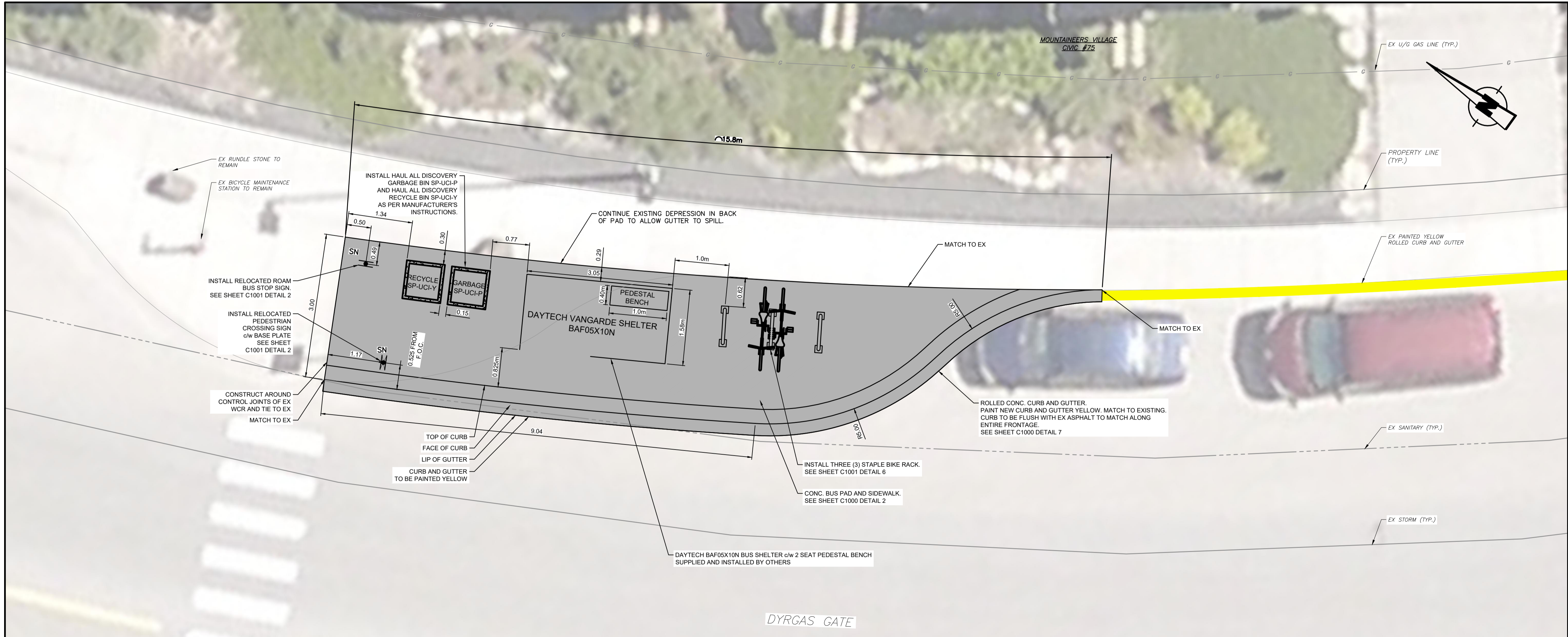

WSP Canada Inc.
729 10 Street, Suite 203
Canmore, AB, Canada T1W 2A3
t:403.678.3500 | f:403.678.3501
www.wsp.com

PERMIT TO PRACTICE
WSP CANADA INC.

RIM SIGNATURE: *[Signature]*
RIM APEGA ID #: 46733
DATE: July 26 2023
PERMIT NUMBER: P007641
The Association of Professional Engineers and Geoscientists of Alberta (APEGA)

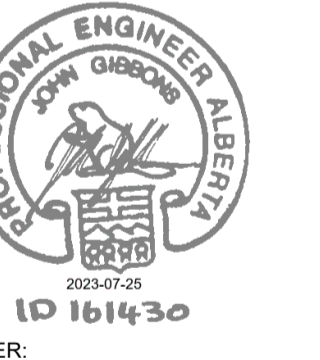

PERMIT:

ENGINEER:

APPROVED:

DATE:

MANAGER OF ENGINEERING

SCALE:

TOWN OF CANMORE

HORZ: 1:50

9

8

7

6

5

4

3

2

1

REV

CONTRACTOR:

WSP Canada Inc.

CONSULTANT FILE NUMBER:

231-01538-00

Town of Canmore
ENGINEERING SERVICES

CAP 7301

TST20 - DYRGAS GATE AT

MOUNTAINEERS VILLAGE

SHEET NO:

C08

TOWN FILE NO:

-

PLAN - BUS STOP TST20 - DYRGAS GATE REMOVALS

1:50

Last Saved: 2023-07-24 11:43:00 AM. By: Arnav, Jesse. Proj: 23101538-00 Bus Stop Removals. Drawn by: Arnav, Jesse. Title: PLAN - BUS STOP TST20 - DYRGAS GATE. Manager: JB. Project: 23101538-00.

Last Saved: 2023-07-24 4:20:30 PM, By: Aileen, Jesse, Proj: Bike-Cafe, Block and Gravel, Z:\2023\21-01538-00-100-General-Engineering-Reviews\21-01538-00-100-General-Engineering-Reviews\21-01538-00-100-General-Engineering-Reviews\21-01538-00-100-General-Engineering-Reviews.dwg, User: Eng1014, H: CAD/C, Project: 2023-07-24 4:20:30 PM, Carey East.dwg

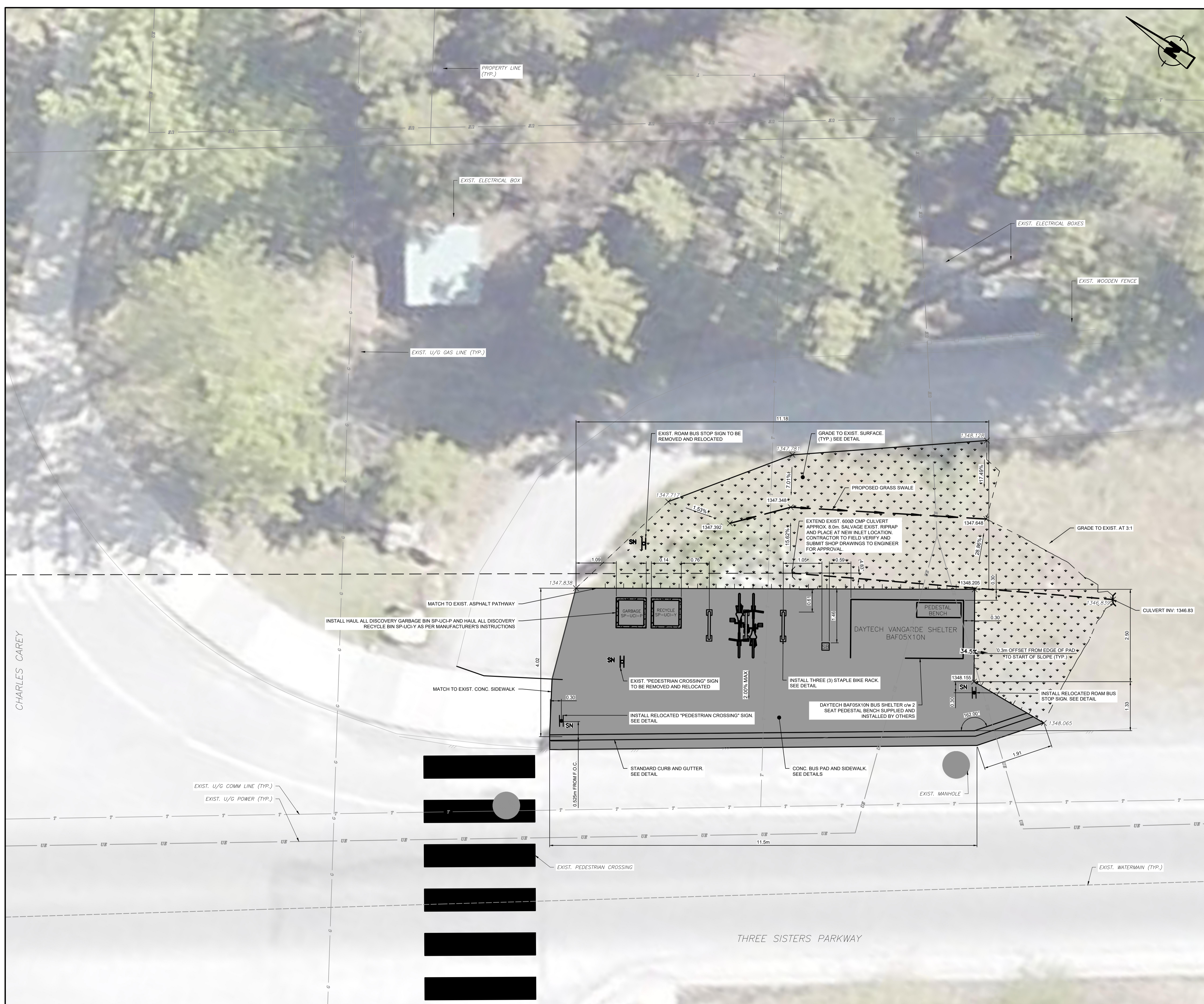

LEGEND	
	PROPERTY LINE (EX.)
	TOP OF SLOPE (PR.)
	BOTTOM OF SLOPE (PR.)
	WATERMAIN (EX.)
	STORM DITCH (PR.)
	STORM CULV (EX.)
	STORM CULV (PR.)
	LOW PRESSURE GAS LINE (EX.)
	UNDERGROUND POWER (EX.)
	UNDERGROUND COMM. (EX.)
	WOOD FENCE (EX.)
	SIGN (EX.)
	SIGN (PR.)
	SOLAR BOLLARD (PR.)
	SPOT ELEVATION (PR.)
	SPOT ELEVATION (EX.)
	CONCRETE BUS PAD/ SIDEWALK (PR.)
	GRASS (PR.)

- NOTES**
- ALL WORK SHALL BE PERFORMED IN ACCORDANCE WITH THE TOWN OF CANMORE'S CURRENT ENGINEERING DESIGN AND CONSTRUCTION GUIDELINES.
 - EXCAVATION PERMITS AND ROAD USE CLOSURE PERMITS WILL BE REQUIRED FROM THE TOWN OF CANMORE FOR ALL WORK WITHIN THE TOWN RIGHT-OF-WAY. THE CONTRACTOR IS RESPONSIBLE FOR NOTIFYING, MAINTAINING, AND COORDINATING ACCESS FOR AFFECTED RESIDENTS.
 - CONTRACTOR IS RESPONSIBLE FOR OBTAINING ALL NECESSARY APPROVALS FROM MUNICIPAL AND PROVINCIAL JURISDICTIONS PRIOR TO CONSTRUCTION INCLUDING EROSION CONTROL.
 - THE LOCATION OF ALL EXISTING INFRASTRUCTURE (HORIZONTAL & VERTICAL) TO BE CONFIRMED BY THE CONTRACTOR IN THE FIELD BEFORE CONSTRUCTION BEGINS.
 - EXISTING GRADES TO BE MAINTAINED.
 - ALL DISTANCES AND ELEVATION ARE IN METRES UNLESS OTHERWISE NOTED.
 - ALL TREES WITHIN GRADING LIMITS TO BE REMOVED.

WSP Canada Inc.
 729 10 Street, Suite 203
 Canmore, AB, Canada T1W 2A3
 t:403.678.3500 | f:403.678.3501
 www.wsp.com

PERMIT TO PRACTICE
WSP CANADA INC.
 RM SIGNATURE: _____
 RM APEGA ID #: 46733
 DATE: July 26 2023
PERMIT NUMBER: P007641
 The Association of Professional Engineers and Geoscientists of Alberta (APEGA)



PERMIT:	ENGINEER:
APPROVED:	DRAWN:
DATE:	DATE:
MANAGER OF ENGINEERING:	SCALE: HORZ: 1:50

REV	YYYY	MM	DD	DESCRIPTION	DPS	CHK	ENG
2	2023	07	24	ISSUED FOR TENDER	JA	JW	JG
1	2023	07	07	ISSUED FOR TOWN APPROVAL	JA	JW	JG

CONSULTANT: WSP Canada Inc. CONSULTANT FILE NUMBER: 231-01538-00

Town of Canmore
 ENGINEERING SERVICES

CAP 7301

TST28 - CAREY EAST

SHEET NO: C09	TOWN FILE NO: -
---------------	-----------------



NOTE: DESIGNS HAVE BEEN BASED ON LIDAR DATA AND ORTHOPHOTO. LAYOUT TO BE REVIEWED ONSITE WITH ENGINEER AND TOWN OF CANMORE REPRESENTATIVE.

LEGEND

- PROPERTY LINE (EX.)
- OVERHEAD UTILITY (EX.)
- WATERMAIN (EX.)
- SANITARY SEWER (EX.)
- STORM SEWER (EX.)
- LOW PRESSURE GAS LINE (EX.)
- UNDERGROUND POWER (EX.)
- SIGN (EX.)
- SOLAR BOLLARD (PR.)
- CONCRETE BUS PAD/SIDEWALK (PR.)

- NOTES**
1. ALL WORK SHALL BE PERFORMED IN ACCORDANCE WITH THE TOWN OF CANMORE'S CURRENT ENGINEERING DESIGN AND CONSTRUCTION GUIDELINES.
 2. EXCAVATION PERMITS AND ROAD USE/CLOSURE PERMITS WILL BE REQUIRED FROM THE TOWN OF CANMORE FOR ALL WORK WITHIN THE TOWN RIGHT-OF-WAY. THE CONTRACTOR IS RESPONSIBLE FOR NOTIFYING, MAINTAINING, AND COORDINATING ACCESS FOR AFFECTED RESIDENTS.
 3. CONTRACTOR IS RESPONSIBLE FOR OBTAINING ALL NECESSARY APPROVALS FROM MUNICIPAL AND PROVINCIAL JURISDICTIONS PRIOR TO CONSTRUCTION INCLUDING EROSION CONTROL.
 4. THE LOCATION OF ALL EXISTING INFRASTRUCTURE (HORIZONTAL & VERTICAL) TO BE CONFIRMED BY THE CONTRACTOR IN THE FIELD BEFORE CONSTRUCTION BEGINS.
 5. EXISTING GRADES TO BE MAINTAINED.
 6. ALL DISTANCES AND ELEVATION ARE IN METRES UNLESS OTHERWISE NOTED.
 7. ALL TREES WITHIN GRADING LIMITS TO BE REMOVED.
 8. ANY LANDSCAPING REHABILITATION WILL REQUIRE SOD.

wsp
 WSP Canada Inc.
 729 10 Street, Suite 203
 Canmore, AB, Canada T1W 2A3
 t:403.678.3500 | f:403.678.3501
 www.wsp.com

**PERMIT TO PRACTICE
 WSP CANADA INC.**

RIM SIGNATURE: *[Signature]*
 RIM APEGA ID #: 46733
 DATE: July 26 2023

PERMIT NUMBER: P007641
 The Association of Professional Engineers and Geoscientists of Alberta (APEGA)

ENGINEER: *[Signature]*
 ID 161430

PERMIT: _____
 APPROVED: _____ DRAWN: JA DATE: 2023-04-03
 SCALE: **HORZ: 1:50**

MANAGER OF ENGINEERING: _____

TOWN OF CANMORE

9										
8										
7										
6										
5										
4										
3										
2	2023	07	24	ISSUED FOR TENDER				JA	JW	JG
1	2023	07	07	ISSUED FOR TOWN APPROVAL				JA	JW	JG
REV	YYYY	MM	DD	DESCRIPTION				DPS	CHK	ENG

CONSULTANT: WSP Canada Inc. CONSULTANT FILE NUMBER: 231-01538-00

Town of Canmore
ENGINEERING SERVICES
 CAP 7301

TST39 - GRIZZLY CRESCENT

SHEET NO: C10 TOWN FILE NO: -

File Saved: 2023-07-24 11:06:49 AM. By: Ameer, Ameer. Print Style: CMC Block and Grid. File Path: Z:\2023\TST39-GRIZZLY CRESCENT\TST39-GRIZZLY CRESCENT.dwg

THREE SISTERS PARKWAY

EXIST. U/G GAS LINE (TYP.)

EXIST. PEDESTRIAN CROSSING

EXTEND EXISTING POST AND ADD RB-25 ABOVE EXISTING SIGN

INSTALL RELOCATED "PEDESTRIAN CROSSING" SIGN. SEE DETAIL

EXIST. "PEDESTRIAN CROSSING" SIGN TO BE REMOVED AND RELOCATED

STANDARD CURB AND GUTTER

REMOVE AND DISPOSE EXIST. WA-31 SIGN AND POST

INSTALL THREE (3) STAPLE BIKE RACK SEE DETAIL

INSTALL SOLAR BOLLARD AS PER MANUFACTURER'S INSTRUCTIONS TO BE SUPPLIED BY THE TOWN OF CANMORE

INSTALL RELOCATED ROAM BUS STOP SIGN. SEE DETAIL

DAYTECH BAF05X10N BUS SHELTER c/w 2 SEAT PEDESTAL BENCH SUPPLIED AND INSTALLED BY OTHERS

NEW WHEELCHAIR RAMP c/w TACTILE WARNING PLATES. SEE DETAIL

GARBAGE SP-UCL-P

RECYCLE SP-UCL-Y

DAYTECH VANGARDE SHELTER BAF05X10N

PEDESTAL BENCH

CULVERT INVERT: 1347.25

CULVERT INVERT: 1346.27

INSTALL HAUL ALL DISCOVERY GARBAGE BIN SP-UCL-P AND HAUL ALL DISCOVERY RECYCLE BIN SP-UCL-Y AS PER MANUFACTURER'S INSTRUCTIONS

EXTEND EXIST. 6000 CMP CULVERT APPROX. 20m. SALVAGE EXISTING RIPRAP AND PLACE AT NEW INLET LOCATION. CONTRACTOR TO FIELD VERIFY AND SUBMIT SHOP DRAWINGS TO ENGINEER FOR APPROVAL.

EXTEND EXIST. 6000 CMP CULVERT APPROX. 20m. SALVAGE EXISTING RIPRAP AND PLACE AT NEW INLET LOCATION

GRADE TO EXIST. SURFACE AT 3:1

EXIST. DIRT PATHWAY

PROP. LINE (TYP.)

LEGEND

- PROPERTY LINE (EX.)
- TOP OF SLOPE (PR.)
- BOTTOM OF SLOPE (PR.)
- STORM CULV (EX.)
- STORM CULV (PR.)
- SN (EX.)
- SN (PR.)
- SOLAR BOLLARD (PR.)
- SPOT ELEVATION (PR.)
- SPOT ELEVATION (EX.)
- CONCRETE BUS PAD/SIDEWALK (PR.)
- GRASS (PR.)

NOTES

- ALL WORK SHALL BE PERFORMED IN ACCORDANCE WITH THE TOWN OF CANMORE'S CURRENT ENGINEERING DESIGN AND CONSTRUCTION GUIDELINES.
- EXCAVATION PERMITS AND ROAD USE/CLOSURE PERMITS WILL BE REQUIRED FROM THE TOWN OF CANMORE FOR ALL WORK WITHIN THE TOWN RIGHT-OF-WAY. THE CONTRACTOR IS RESPONSIBLE FOR NOTIFYING, MAINTAINING, AND COORDINATING ACCESS FOR AFFECTED RESIDENTS.
- CONTRACTOR IS RESPONSIBLE FOR OBTAINING ALL NECESSARY APPROVALS FROM MUNICIPAL AND PROVINCIAL JURISDICTIONS PRIOR TO CONSTRUCTION INCLUDING EROSION CONTROL.
- THE LOCATION OF ALL EXISTING INFRASTRUCTURE (HORIZONTAL & VERTICAL) TO BE CONFIRMED BY THE CONTRACTOR IN THE FIELD BEFORE CONSTRUCTION BEGINS.
- EXISTING GRADES TO BE MAINTAINED.
- ALL DISTANCES AND ELEVATION ARE IN METRES UNLESS OTHERWISE NOTED.
- ALL TREES WITHIN GRADING LIMITS TO BE REMOVED.



WSP Canada Inc. 729 10 Street, Suite 203 Canmore, AB, Canada T1W 2A3 t:403.678.3500 | f:403.678.3501 www.wsp.com

PERMIT TO PRACTICE WSP CANADA INC.

RM SIGNATURE: [Signature] RM APEGA ID #: 46733 DATE: July 26 2023 PERMIT NUMBER: P007641 The Association of Professional Engineers and Geoscientists of Alberta (APEGA)



PERMIT: ENGINEER: APPROVED: DRAWN: DATE: 2023-04-03

MANAGER OF ENGINEERING: SCALE: HORZ: 1:50

REV	YYYY	MM	DD	DESCRIPTION	DPS	CHK	ENG
2	2023	07	24	ISSUED FOR TENDER	JA	JW	JG
1	2023	07	07	ISSUED FOR TOWN APPROVAL	JA	JW	JG

CONSULTANT: WSP Canada Inc. CONSULTANT FILE NUMBER: 231-01538-00

Town of Canmore ENGINEERING SERVICES

CAP 7301

TST46 - CAREY WEST

SHEET NO: C11 TOWN FILE NO: -

File Saved: 2023-07-24 12:38:21 PM, By: Aron, Jesse, Proj: 5146, C:\Users\Aron\OneDrive\Documents\TST46 - Carey West\Drawings\CAD\23-07-24\TST46 - Carey West.dwg, 23-07-24 12:38:21 PM, C:\Users\Aron\OneDrive\Documents\TST46 - Carey West\Drawings\CAD\23-07-24\TST46 - Carey West.dwg



LEGEND

PROPERTY LINE (EX.)
 TOP OF SLOPE (PR.)
 BOTTOM OF SLOPE (PR.)
 SANITARY SEWER (EX.)
 STORM CULV (EX.)
 LOW PRESSURE GAS LINE (EX.)
 UNDERGROUND POWER (EX.)
 UNDERGROUND COMM. (EX.)
 SIGN (EX.)
 SIGN (PR.)
 SOLAR BOLLARD (PR.)
 SPOT ELEVATION (PR.)
 SPOT ELEVATION (EX.)
 CONCRETE BUS PAD/
SIDEWALK (PR.)
 GRASS (PR.)
 CONCRETE (EX.)

NOTES

1. ALL WORK SHALL BE PERFORMED IN ACCORDANCE WITH THE TOWN OF CANMORE'S CURRENT ENGINEERING DESIGN AND CONSTRUCTION GUIDELINES.
2. EXCAVATION PERMITS AND ROAD USE/CLOSURE PERMITS WILL BE REQUIRED FROM THE TOWN OF CANMORE FOR ALL WORK WITHIN THE TOWN RIGHT-OF-WAY. THE CONTRACTOR IS RESPONSIBLE FOR NOTIFYING, MAINTAINING, AND COORDINATING ACCESS FOR AFFECTED RESIDENTS.
3. CONTRACTOR IS RESPONSIBLE FOR OBTAINING ALL NECESSARY APPROVALS FROM MUNICIPAL AND PROVINCIAL JURISDICTIONS PRIOR TO CONSTRUCTION INCLUDING EROSION CONTROL.
4. THE LOCATION OF ALL EXISTING INFRASTRUCTURE (HORIZONTAL & VERTICAL) TO BE CONFIRMED BY THE CONTRACTOR IN THE FIELD BEFORE CONSTRUCTION BEGINS.
5. EXISTING GRADES TO BE MAINTAINED.
6. ALL DISTANCES AND ELEVATION ARE IN METRES UNLESS OTHERWISE NOTED.
7. ALL TREES WITHIN GRADING LIMITS TO BE REMOVED.

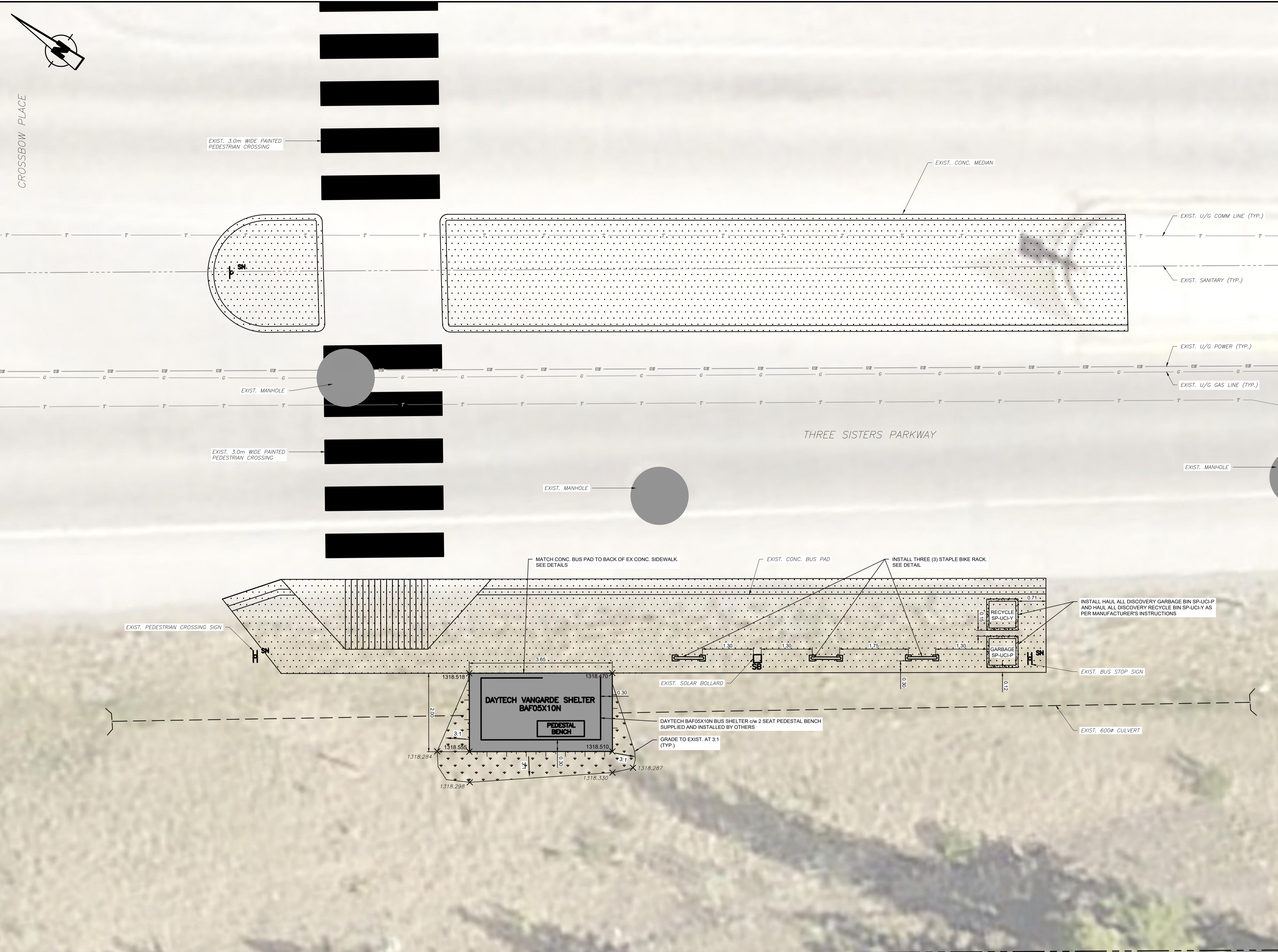

WSP Canada Inc.
 729 10 Street, Suite 203
 Canmore, AB, Canada T1W 2A3
 t:403.678.3500 | f:403.678.3501
 www.wsp.com

PERMIT TO PRACTICE WSP CANADA INC.

RM SIGNATURE:
 RM APEGA ID #: 46733
 DATE: July 26 2023
PERMIT NUMBER: P007641
The Association of Professional Engineers and Geoscientists of Alberta (APEGA)

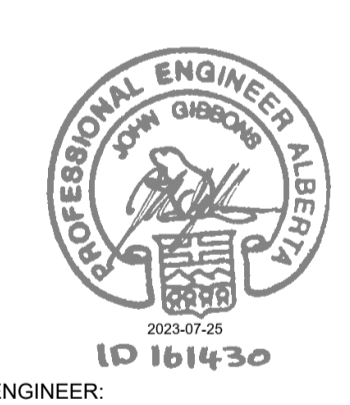

APPROVED:	DRAWN: JA	DATE: 2023-04-03
MANAGER OF ENGINEERING	SCALE: HORZ: 1:50	
TOWN OF CANMORE		

9									
8									
7									
6									
5									
4									
3									
2	2023	07	24	ISSUED FOR TENDER	JA	JW	JG		
1	2023	07	07	ISSUED FOR TOWN APPROVAL	JA	JW	JG		
REV	YYYY	MM	DD	DESCRIPTION	DPS	CHK	ENG		

CONSULTANT: WSP Canada Inc. CONSULTANT FILE NUMBER: 231-01538-00
Town of Canmore
 ENGINEERING SERVICES
 CAP 7301

TST64 - CROSSBOW PLACE
SOUTH
 SHEET NO: C13 TOWN FILE NO: -

Lint Based 2023-07-24 12:26:40 PM By: Aron, Jesse Per Day CIVIC Blank and Gray.cbr
 C:\Users\aron\OneDrive\Documents\CAD\2023\2023-07-24\2023-07-24\TST64 - CROSSBOW PLACE\TST64 - CROSSBOW PLACE.dwg

CIVIC #217

CIVIC #213

CIVIC #209

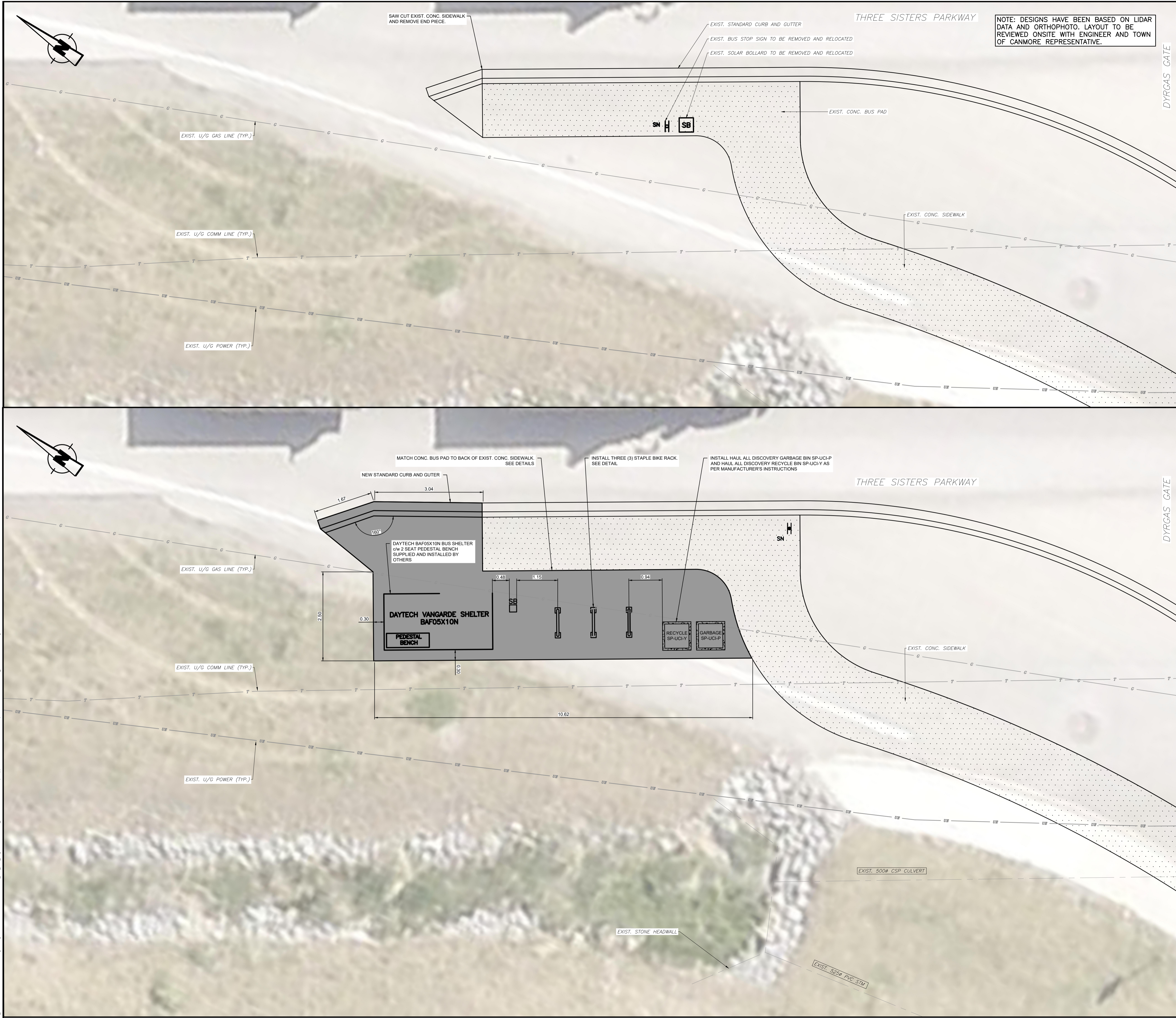

NOTE: DESIGNS HAVE BEEN BASED ON LIDAR DATA AND ORTHOPHOTO. LAYOUT TO BE REVIEWED ONSITE WITH ENGINEER AND TOWN OF CANMORE REPRESENTATIVE.

LEGEND

	PROPERTY LINE (EX.)
	TOP OF SLOPE (PR.)
	BOTTOM OF SLOPE (PR.)
	LOW PRESSURE GAS LINE (EX.)
	UNDERGROUND POWER (EX.)
	UNDERGROUND COMM. (EX.)
	SIGN (EX.)
	SIGN (PR.)
	SOLAR BOLLARD (PR.)
	CONCRETE BUS PAD/ SIDEWALK (PR.)
	CONCRETE (EX.)

- NOTES**
- ALL WORK SHALL BE PERFORMED IN ACCORDANCE WITH THE TOWN OF CANMORE'S CURRENT ENGINEERING DESIGN AND CONSTRUCTION GUIDELINES.
 - EXCAVATION PERMITS AND ROAD USE/CLOSURE PERMITS WILL BE REQUIRED FROM THE TOWN OF CANMORE FOR ALL WORK WITHIN THE TOWN RIGHT-OF-WAY. THE CONTRACTOR IS RESPONSIBLE FOR NOTIFYING, MAINTAINING, AND COORDINATING ACCESS FOR AFFECTED RESIDENTS.
 - CONTRACTOR IS RESPONSIBLE FOR OBTAINING ALL NECESSARY APPROVALS FROM MUNICIPAL AND PROVINCIAL JURISDICTIONS PRIOR TO CONSTRUCTION INCLUDING EROSION CONTROL.
 - THE LOCATION OF ALL EXISTING INFRASTRUCTURE (HORIZONTAL & VERTICAL) TO BE CONFIRMED BY THE CONTRACTOR IN THE FIELD BEFORE CONSTRUCTION BEGINS.
 - EXISTING GRADES TO BE MAINTAINED.
 - ALL DISTANCES AND ELEVATION ARE IN METRES UNLESS OTHERWISE NOTED.
 - ALL TREES WITHIN GRADING LIMITS TO BE REMOVED.
 - NON PERMEABLE BARRIER IS REQUIRED. SEE DETAIL 1 ON SHEET C1000.

wsp

WSP Canada Inc.
729 10 Street, Suite 203
Canmore, AB, Canada T1W 2A3
t:403.678.3500 | f:403.678.3501
www.wsp.com

PERMIT TO PRACTICE
WSP CANADA INC.

RM SIGNATURE:

RM APEGA ID #: 46733

DATE: July 26 2023

PERMIT NUMBER: P007641

The Association of Professional Engineers and Geoscientists of Alberta (APEGA)

ENGINEER:

PERMIT: _____

APPROVED: _____

DRAWN: JA

DATE: 2023-04-03

SCALE: **HORZ: 1:50**

MANAGER OF ENGINEERING: _____

TOWN OF CANMORE: _____

9										
8										
7										
6										
5										
4										
3										
2	2023	07	24	ISSUED FOR TENDER	JA	JW	JG			
1	2023	07	07	ISSUED FOR TOWN APPROVAL	AA	JW	JG			
REV	YYYY	MM	DD	DESCRIPTION	DPS	CHK	ENG			

CONSULTANT: WSP Canada Inc. CONSULTANT FILE NUMBER: 231-01538-00

Town of **CANMORE** ENGINEERING SERVICES

CAP 7301

TST65 - THREE SISTERS @ DYRGAS GATE

SHEET NO: C14 TOWN FILE NO: -

Lin: S:\2023\07\24 1:58:44 PM: By: Ameer, Ameer - Proj: Site CAC Block and Gravel
 2_2023\24\1538-00 - 00 - General Engineering Documents: Technical\Site Land Dev_Am...
 2023-07-25 10:05:04 AM: J:\2023_Productions\2023 Bus Stop\Approved\Site\Address\Bus Stop\Site CAC Block and Gravel.dwg

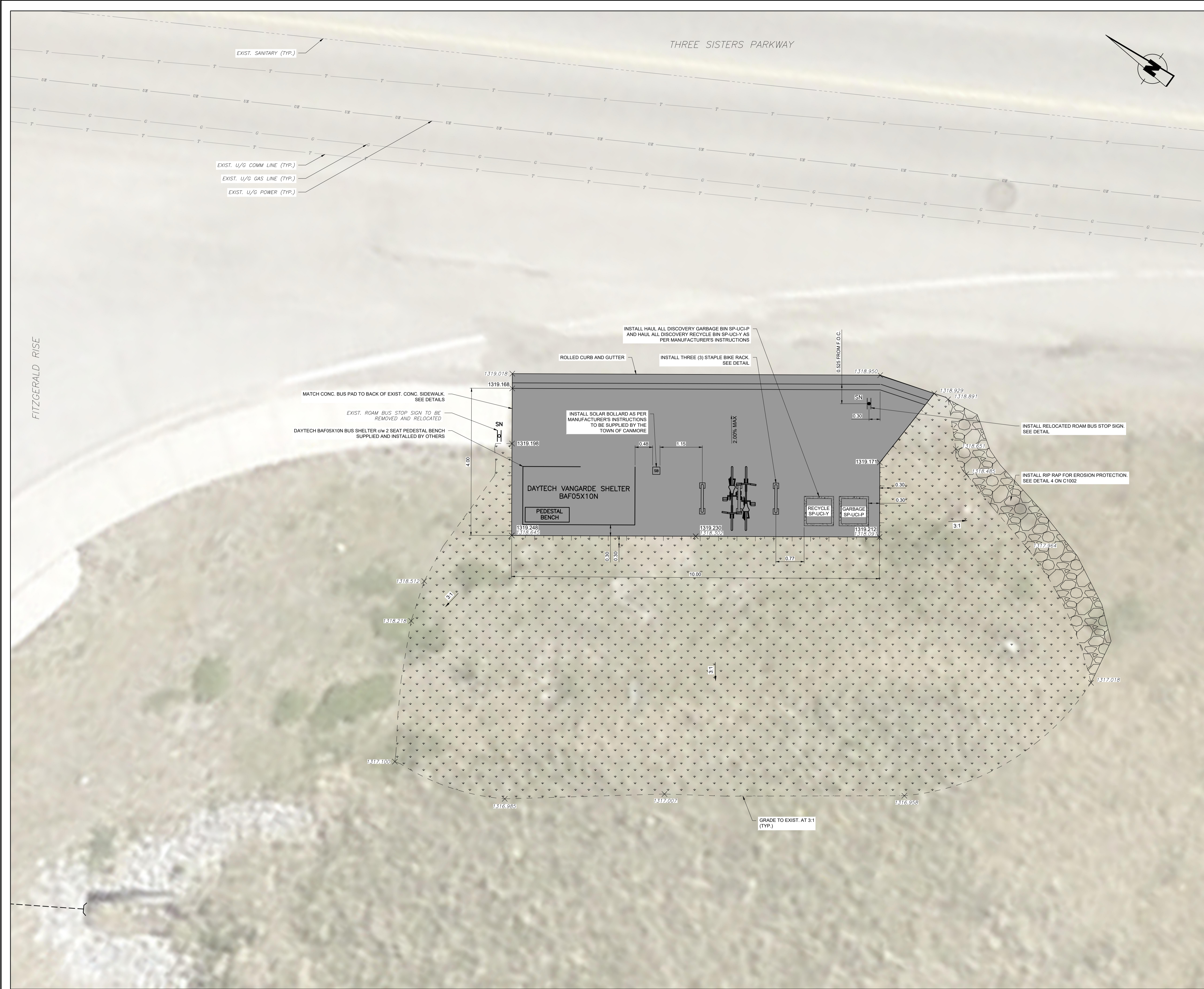

LEGEND

	PROPERTY LINE (EX.)
	TOP OF SLOPE (PR.)
	BOTTOM OF SLOPE (PR.)
	SANITARY SEWER (EX.)
	LOW PRESSURE GAS LINE (EX.)
	UNDERGROUND POWER (EX.)
	UNDERGROUND COMM. (EX.)
	SIGN (EX.)
	SIGN (PR.)
	SOLAR BOLLARD (PR.)
	SPOT ELEVATION (PR.)
	SPOT ELEVATION (EX.)
	CONCRETE BUS PAD/ SIDEWALK (PR.)
	GRASS (PR.)
	RIPRAP (PR.)

- NOTES**
1. ALL WORK SHALL BE PERFORMED IN ACCORDANCE WITH THE TOWN OF CANMORE'S CURRENT ENGINEERING DESIGN AND CONSTRUCTION GUIDELINES.
 2. EXCAVATION PERMITS AND ROAD USE/CLOSURE PERMITS WILL BE REQUIRED FROM THE TOWN OF CANMORE FOR ALL WORK WITHIN THE TOWN RIGHT-OF-WAY. THE CONTRACTOR IS RESPONSIBLE FOR NOTIFYING, MAINTAINING, AND COORDINATING ACCESS FOR AFFECTED RESIDENTS.
 3. CONTRACTOR IS RESPONSIBLE FOR OBTAINING ALL NECESSARY APPROVALS FROM MUNICIPAL AND PROVINCIAL JURISDICTIONS PRIOR TO CONSTRUCTION INCLUDING EROSION CONTROL.
 4. THE LOCATION OF ALL EXISTING INFRASTRUCTURE (HORIZONTAL & VERTICAL) TO BE CONFIRMED BY THE CONTRACTOR IN THE FIELD BEFORE CONSTRUCTION BEGINS.
 5. EXISTING GRADES TO BE MAINTAINED.
 6. ALL DISTANCES AND ELEVATION ARE IN METRES UNLESS OTHERWISE NOTED.
 7. ALL TREES WITHIN GRADING LIMITS TO BE REMOVED.



PERMIT TO PRACTICE
WSP CANADA INC.
 RM SIGNATURE: *[Signature]*
 RM APEGA ID #: 46733
 DATE: July 26 2023
PERMIT NUMBER: P007641
 The Association of Professional Engineers and Geoscientists of Alberta (APEGA)

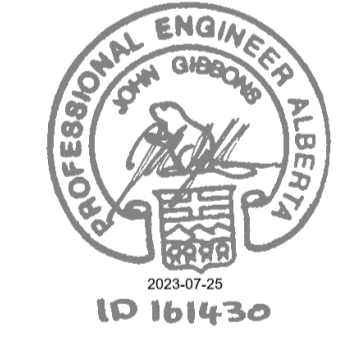

ENGINEER: _____
 APPROVED: _____ DATE: 2023-04-03
 DRAWN: JA
 SCALE: **HORZ: 1:50**
 MANAGER OF ENGINEERING: _____
 TOWN OF CANMORE

9									
8									
7									
6									
5									
4									
3									
2	2023	07	24	ISSUED FOR TENDER		JA	JW	JG	
1	2023	07	07	ISSUED FOR TOWN APPROVAL		JA	JW	JG	
REV	YYYY	MM	DD	DESCRIPTION		DPS	CHK	ENG	

CONSULTANT: WSP Canada Inc. CONSULTANT FILE NUMBER: 231-01538-00

Town of CANMORE **Town of Canmore ENGINEERING SERVICES**

CAP 7301

TST77 - THREE SISTERS AT FITZGERALD RISE

SHEET NO: C15 TOWN FILE NO: -

Last Saved: 2023-07-24 12:59:07 PM. By: Anwar, Jesse. Plot Style: C:\C:\Users\jess@wsp.com\AppData\Local\Temp\2023-07-24 12:59:07 PM\TST77 - FITZGERALD.rvt
 Z:\2023\231-01538-00\General Engineering Services\TST77 - FITZGERALD.rvt

NOTE: DESIGNS HAVE BEEN BASED ON LIDAR DATA AND ORTHOPHOTO. LAYOUT TO BE REVIEWED ONSITE WITH ENGINEER AND TOWN OF CANMORE REPRESENTATIVE.

THE SUMMIT CAFE
CIVIC #1001

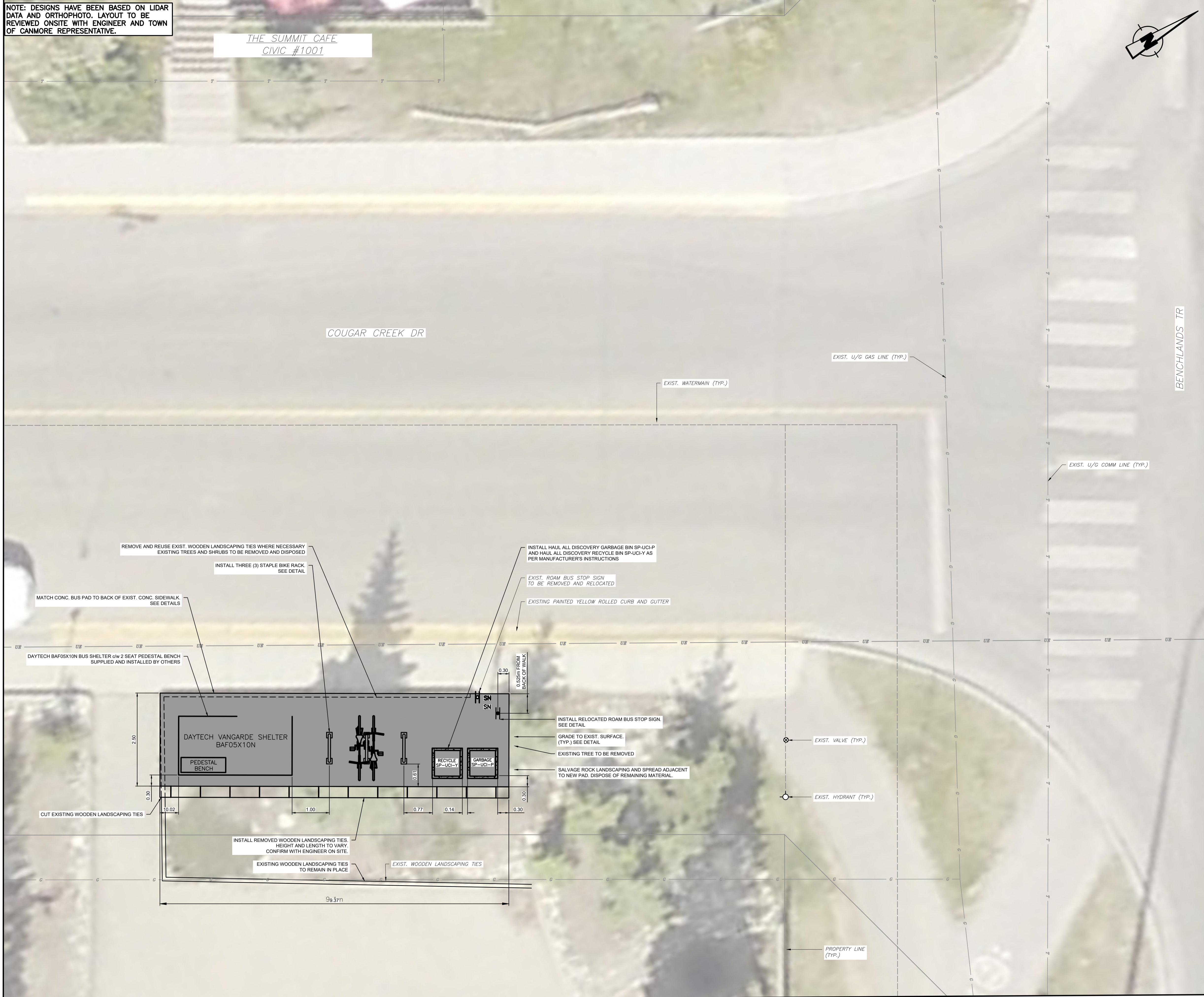
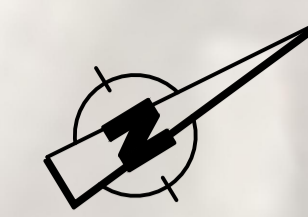

LEGEND	
	PROPERTY LINE (EX.)
	WATERMAIN (EX.)
	LOW PRESSURE GAS LINE (EX.)
	UNDERGROUND POWER (EX.)
	UNDERGROUND COMM. (EX.)
	SIGN (EX.)
	SIGN (PR.)
	SOLAR BOLLARD (PR.)
	CONCRETE BUS PAD/ SIDEWALK (PR.)
	LANDSCAPING TIES
	LANDSCAPING TIES (REMOVE)

NOTES

1. ALL WORK SHALL BE PERFORMED IN ACCORDANCE WITH THE TOWN OF CANMORE'S CURRENT ENGINEERING DESIGN AND CONSTRUCTION GUIDELINES.
2. EXCAVATION PERMITS AND ROAD USE/CLOSURE PERMITS WILL BE REQUIRED FROM THE TOWN OF CANMORE FOR ALL WORK WITHIN THE TOWN RIGHT-OF-WAY. THE CONTRACTOR IS RESPONSIBLE FOR NOTIFYING, MAINTAINING, AND COORDINATING ACCESS FOR AFFECTED RESIDENTS.
3. CONTRACTOR IS RESPONSIBLE FOR OBTAINING ALL NECESSARY APPROVALS FROM MUNICIPAL AND PROVINCIAL JURISDICTIONS PRIOR TO CONSTRUCTION INCLUDING EROSION CONTROL.
4. THE LOCATION OF ALL EXISTING INFRASTRUCTURE (HORIZONTAL & VERTICAL) TO BE CONFIRMED BY THE CONTRACTOR IN THE FIELD BEFORE CONSTRUCTION BEGINS.
5. EXISTING GRADES TO BE MAINTAINED.
6. ALL DISTANCES AND ELEVATION ARE IN METRES UNLESS OTHERWISE NOTED.
7. ALL TREES WITHIN GRADING LIMITS TO BE REMOVED.



WSP Canada Inc.
729 10 Street, Suite 203
Canmore, AB, Canada T1W 2A3
t:403.678.3500 | f:403.678.3501
www.wsp.com

PERMIT TO PRACTICE
WSP CANADA INC.
RIM SIGNATURE: *[Signature]*
RIM APEGA ID #: 46733
DATE: July 26 2023
PERMIT NUMBER: P007641
The Association of Professional Engineers and Geoscientists of Alberta (APEGA)

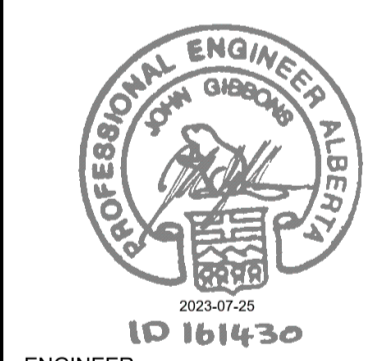

PERMIT: _____ ENGINEER: _____

APPROVED: _____ DRAWN: JA DATE: 2023-04-03

MANAGER OF ENGINEERING: _____ SCALE: **HORZ: 1:50**

TOWN OF CANMORE							
9							
8							
7							
6							
5							
4							
3							
2	2023	07	24	ISSUED FOR TENDER	JA	JW JG	
1	2023	07	07	ISSUED FOR TOWN APPROVAL	JA	JW JG	
REV	YYYY	MM	DD	DESCRIPTION	DPS	CHK	ENG

CONSULTANT: WSP Canada Inc. CONSULTANT FILE NUMBER: 231-01538-00

Town of Canmore
ENGINEERING SERVICES

CAP 7301

TST26 - SUMMIT CAFE EAST

SHEET NO: C16 TOWN FILE NO: -

Last Saved: 2023-07-24 12:39:12 PM By: Arno, Jesse File: B:\M\CAD\Buck and Gray\B...
 Z:\2023\21-01538-00\TST26 - Summit Cafe East\Drawings\TST26 - Summit Cafe East.dwg

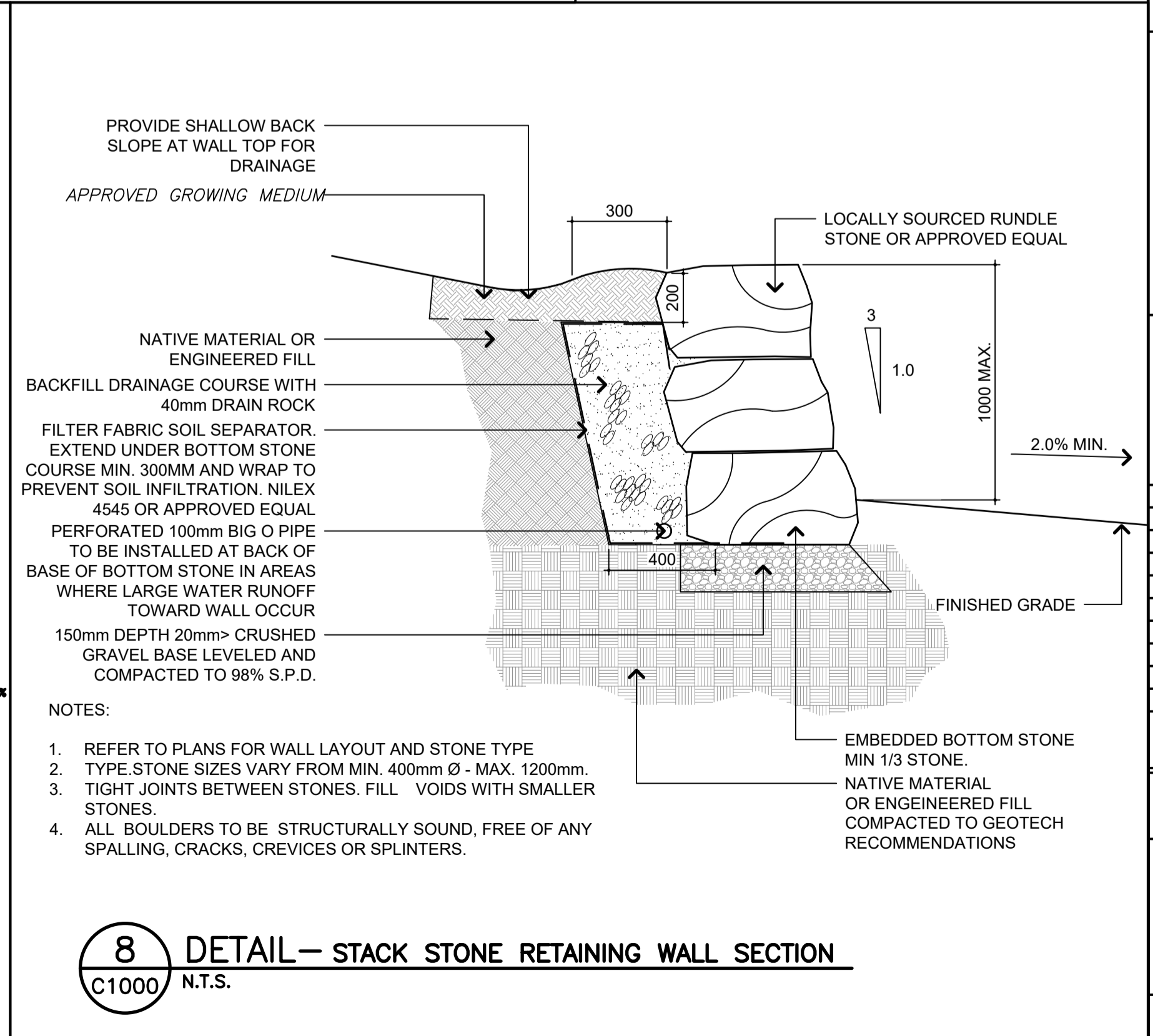
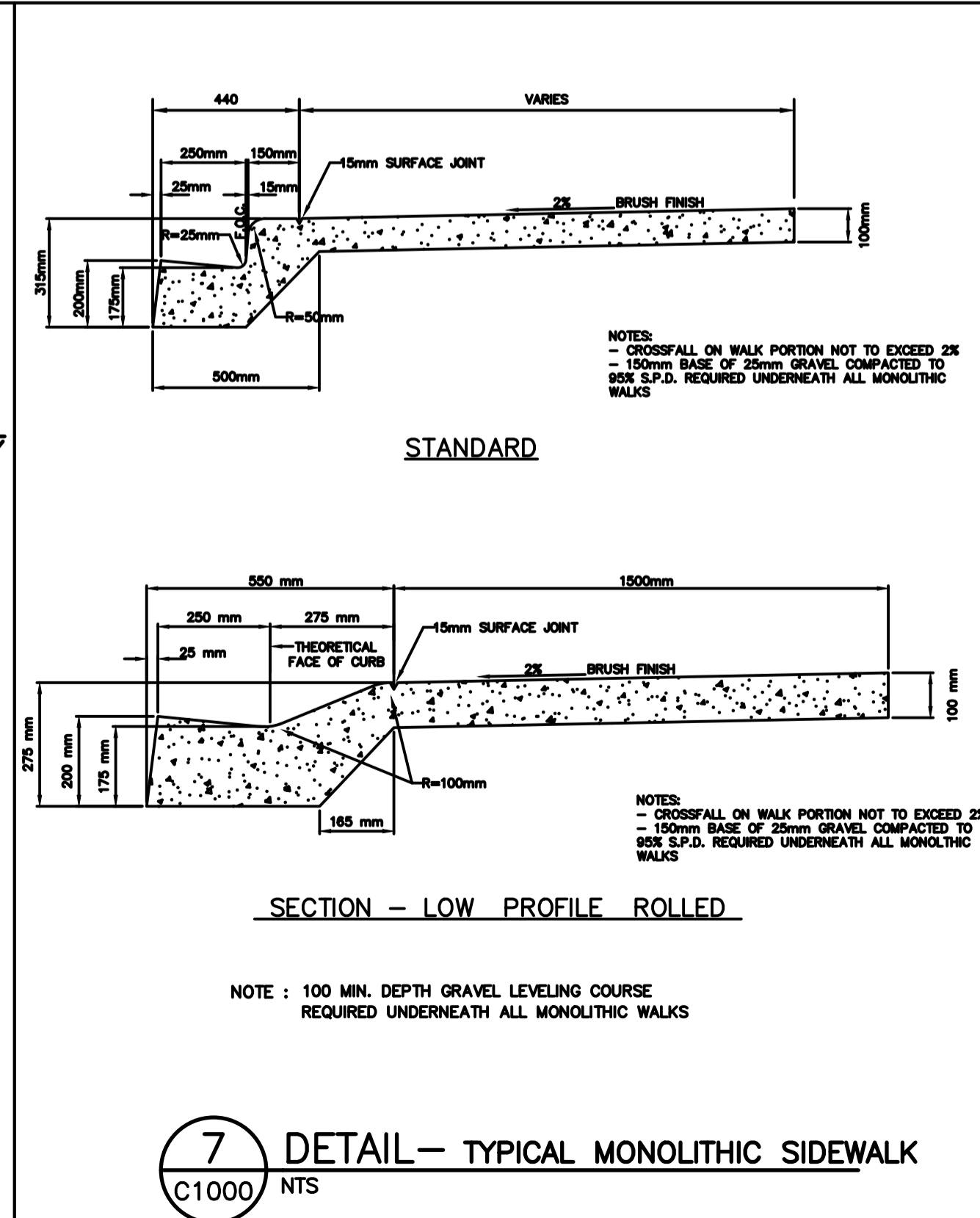
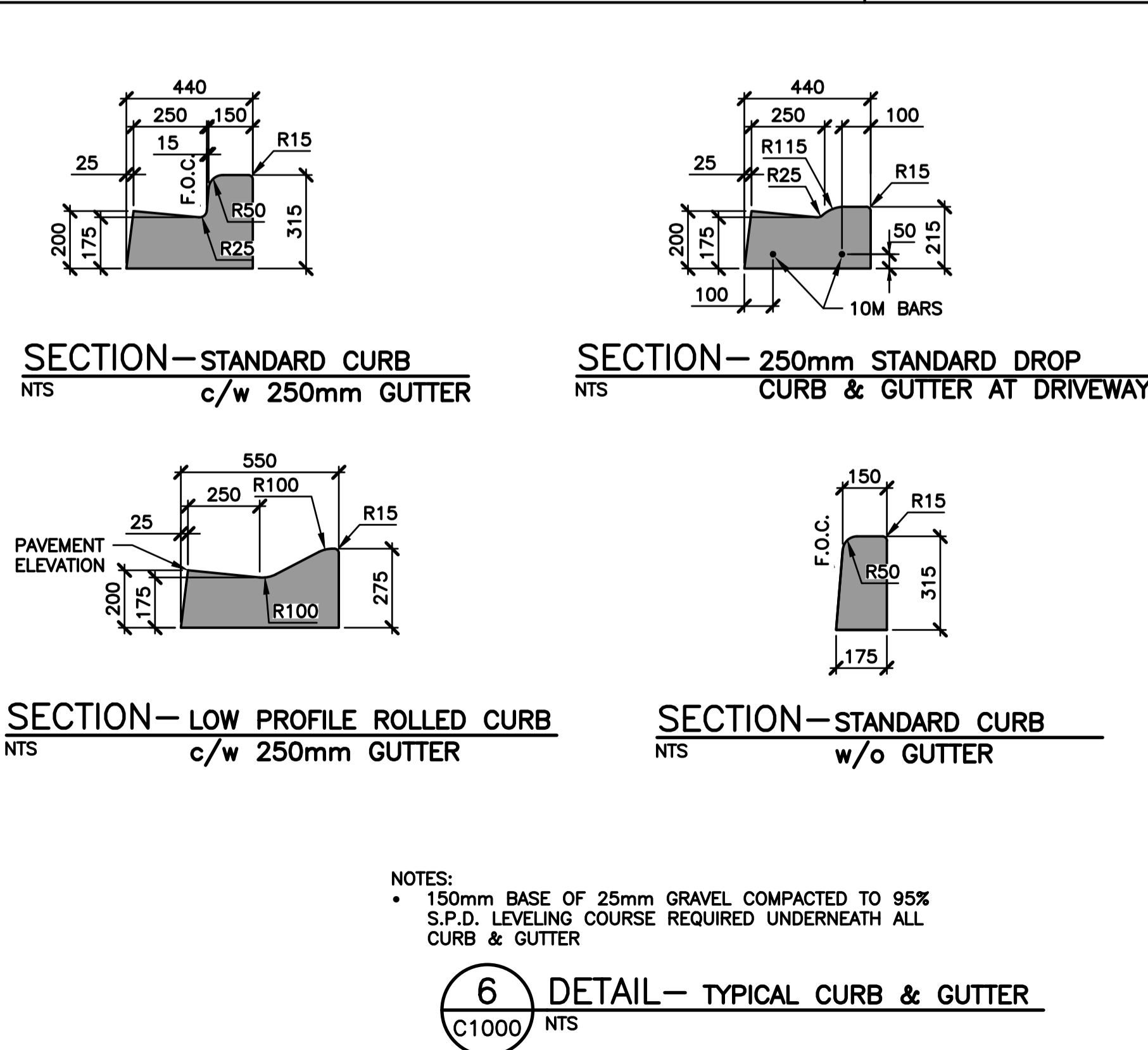
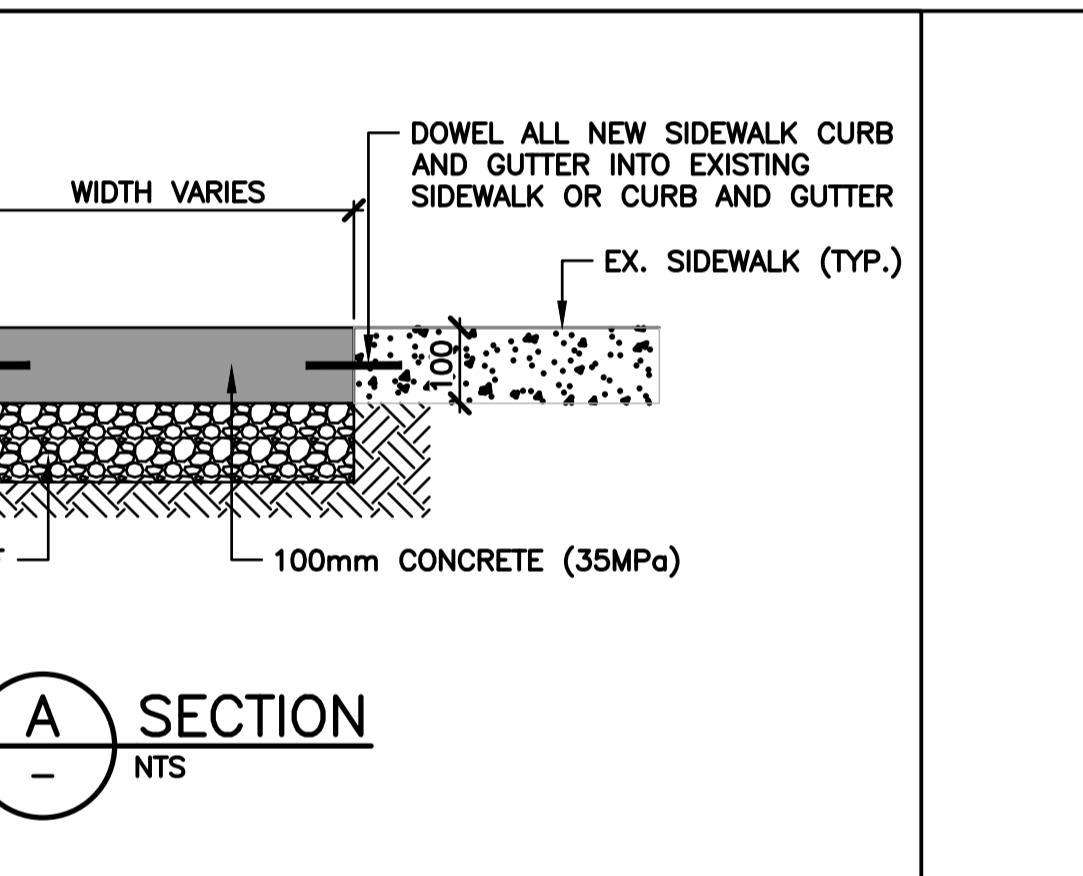
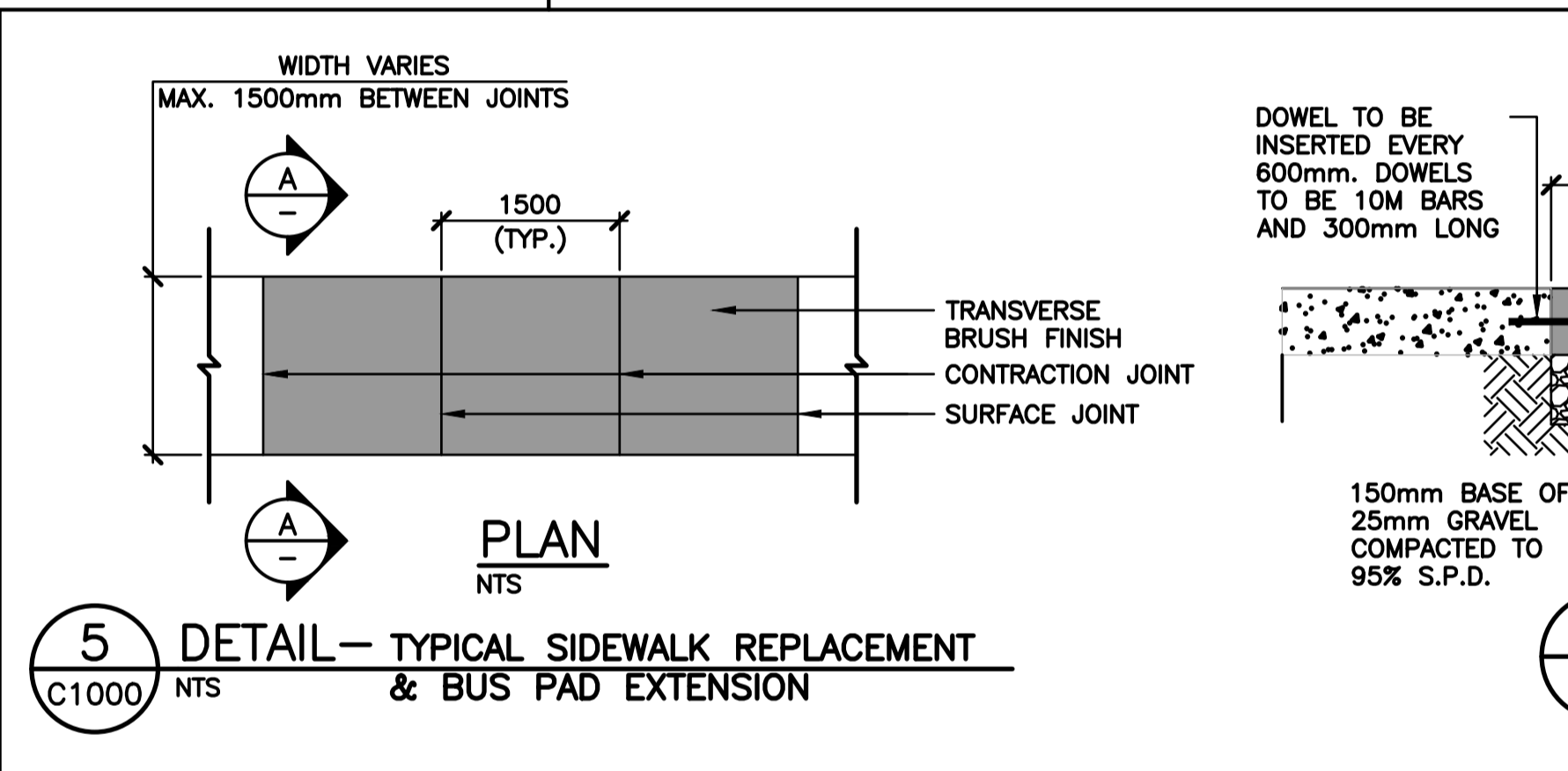
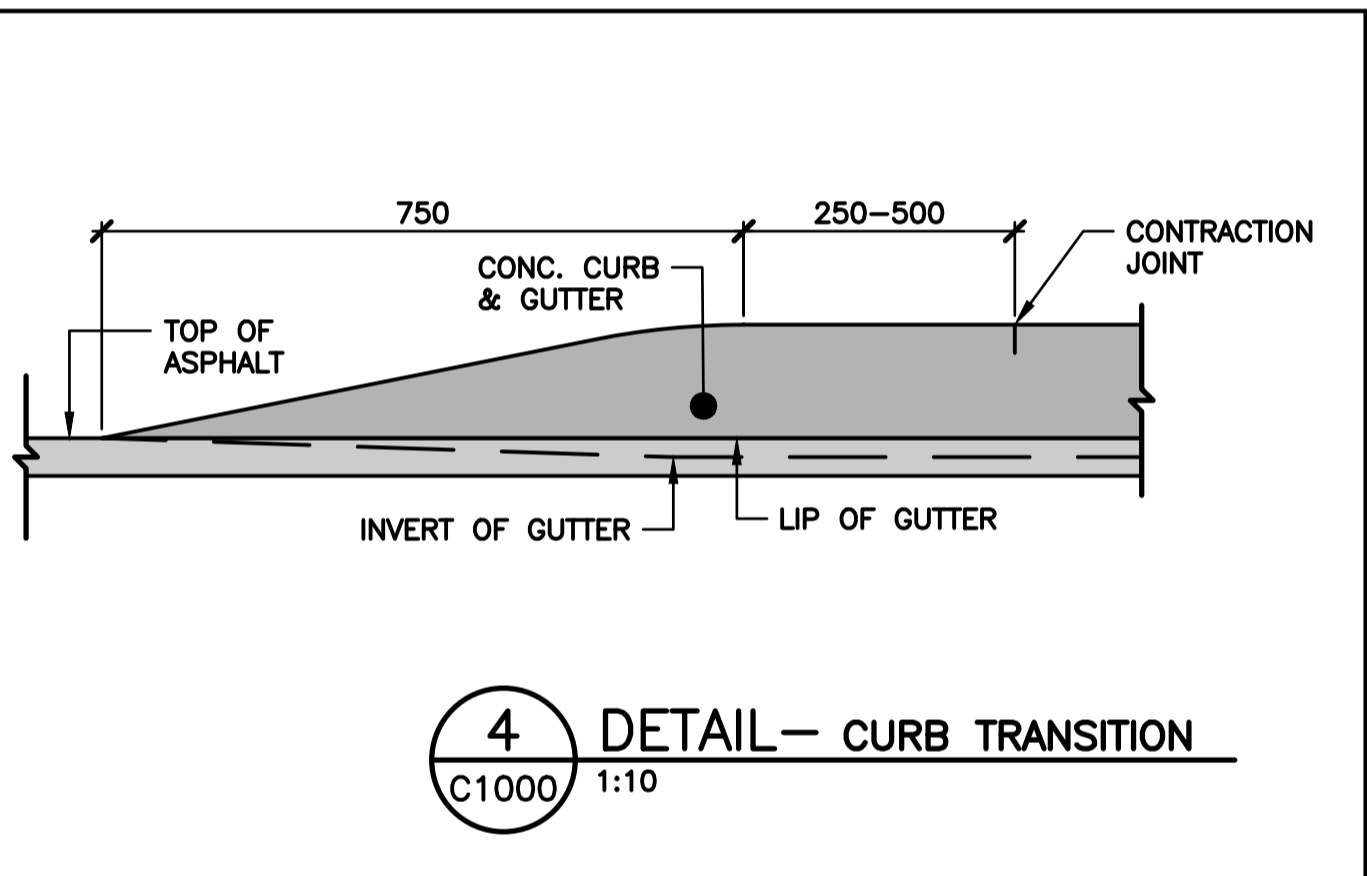
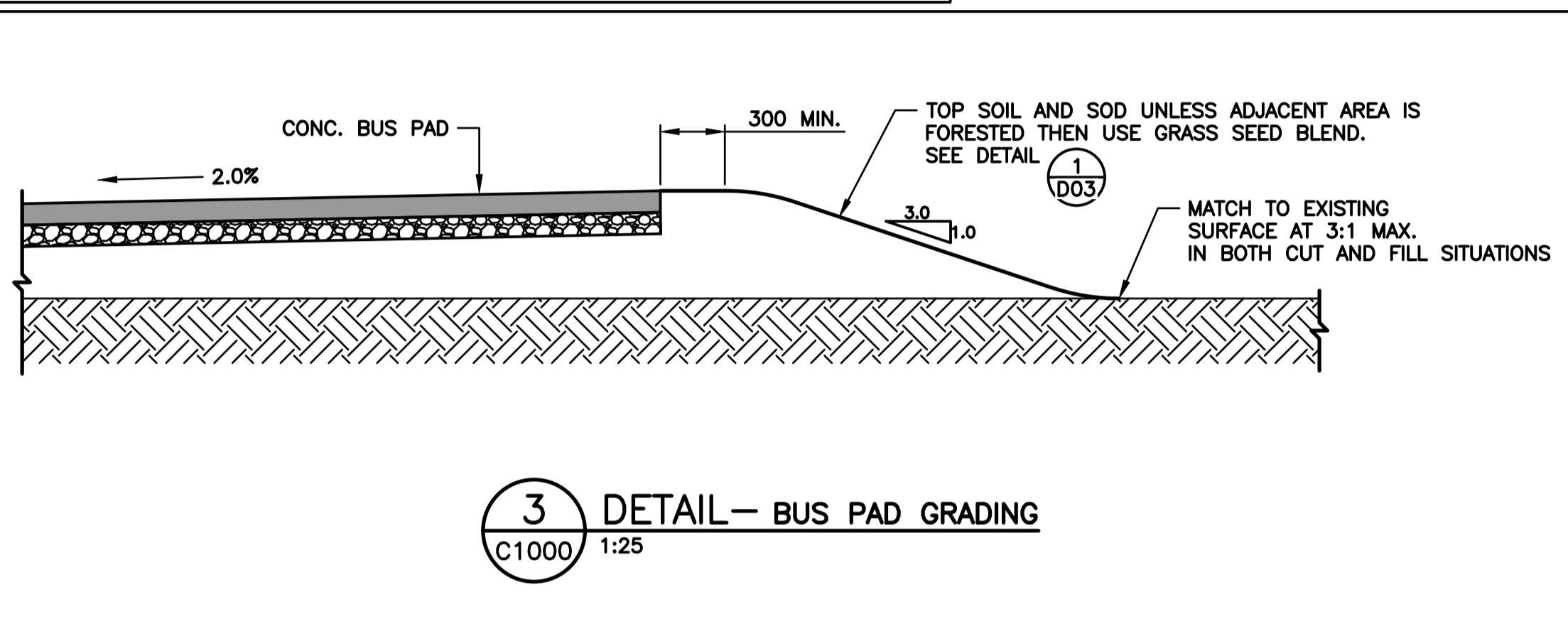
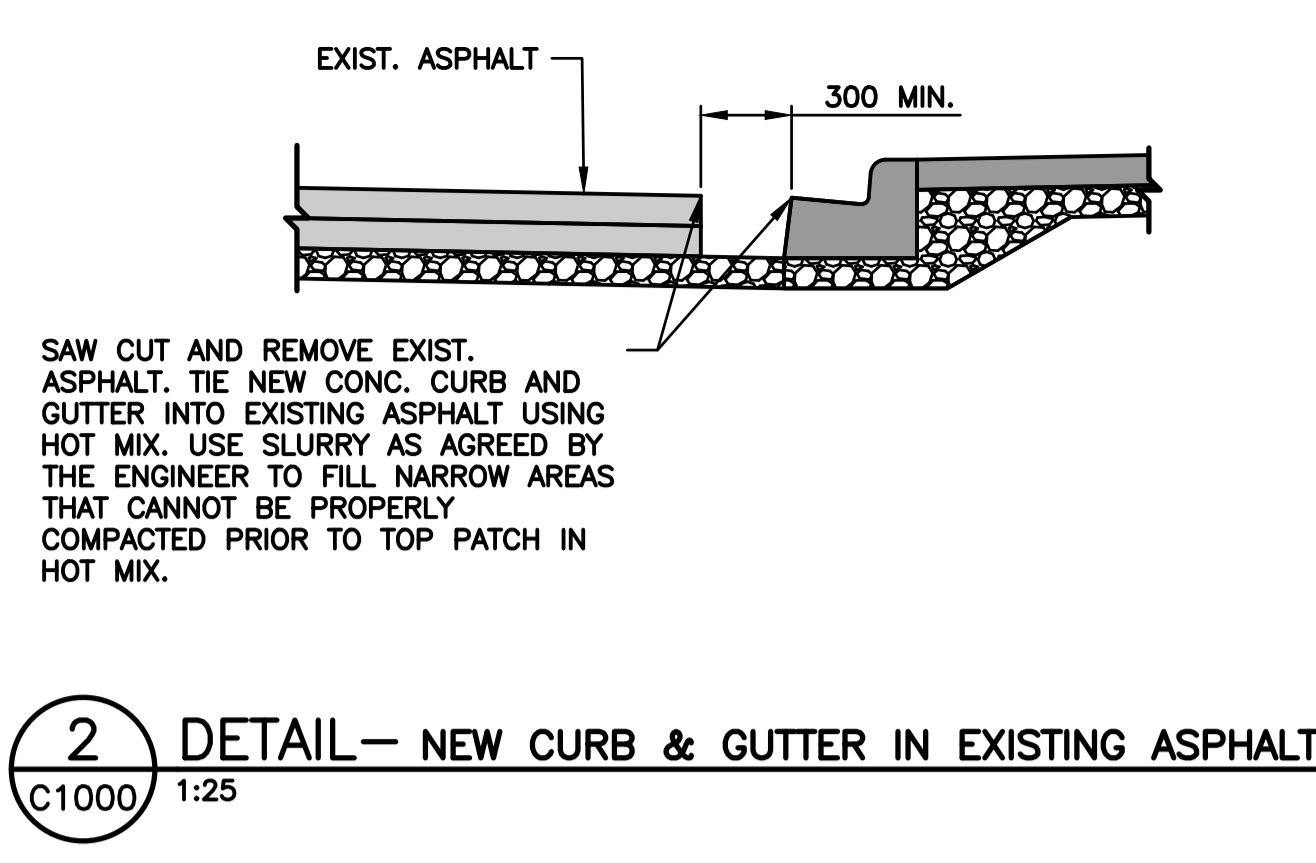
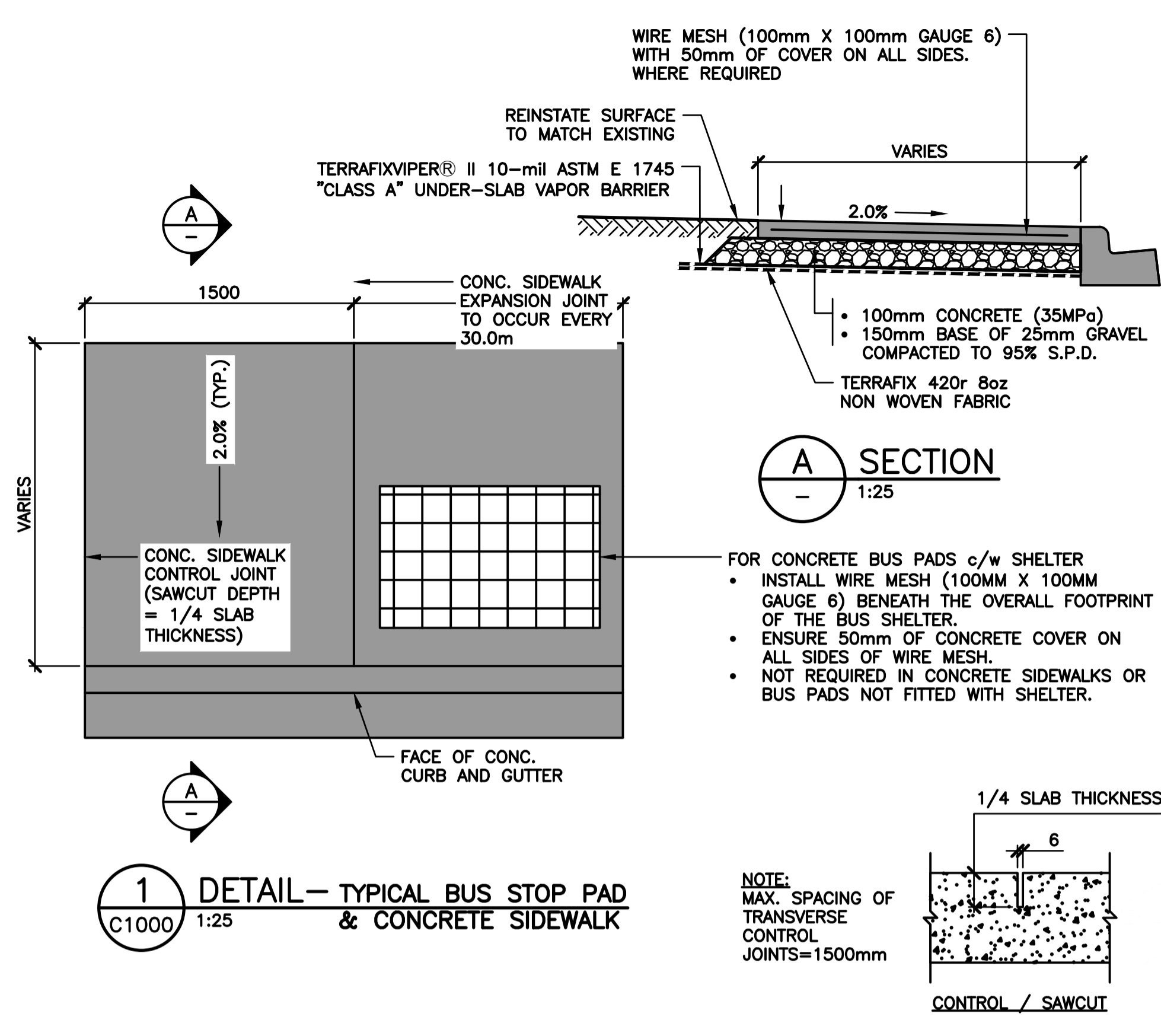

- GENERAL NOTES**
- ALL DIMENSIONS ARE IN MILLIMETRES UNLESS OTHERWISE NOTED.
 - PROPERTY LINE INFORMATION APPROXIMATE ONLY.
 - COMPLY WITH ALL ENVIRONMENTAL REGULATIONS.
 - ALL WORK SHALL BE IN ACCORDANCE WITH THE PROVINCIAL HEALTH AND SAFETY ORDINANCES AND REGULATIONS AND ALL PROVINCIAL AND MUNICIPAL REGULATIONS, STANDARDS AND APPROVALS.
 - EXISTING UTILITY INFORMATION IS APPROXIMATE ONLY. CONTRACTOR TO CONFIRM LOCATION AND SIZE OF ALL EXISTING INFRASTRUCTURE IF REQUIRED. ENGINEER TO BE NOTIFIED OF ANY DISCREPANCIES BETWEEN DESIGN AND EXISTING CONDITIONS PRIOR TO CONSTRUCTION.
 - ALL WORK TO BE DONE IN ACCORDANCE WITH THE ALBERTA MUNICIPAL SERVICES AND TO THE PROJECT SPECIFICATIONS. WHEN CONFLICTS BETWEEN THE DOCUMENTS OCCUR, THE MORE STRINGENT SHALL APPLY AS DIRECTED BY ENGINEER.
 - TRAFFIC SIGNS ARE NOT TO BE REMOVED OR REPLACED WITHOUT AUTHORIZATION FROM TRAFFIC AUTHORITY AND THE ENGINEER.
 - ARRANGE FOR AND PAY FOR ALL TEMPORARY SERVICES SUCH AS POWER, SANITARY AND STORM SEWER AND WATER SUPPLY DURING CONSTRUCTION AS REQUIRED.
 - PAVEMENT MARKINGS TO BE REPAINTED IN EXISTING LOCATIONS. REINSTATE PAVEMENT MARKINGS TO NEW CONDITION.

wsp

WSP Canada Inc.
729 10 Street, Suite 203
Canmore, AB, Canada T1W 2A3
t:403.678.3500 | f:403.678.3501
www.wsp.com

PERMIT TO PRACTICE
WSP CANADA INC.

RM SIGNATURE: _____
RM APEGA ID #: 46733
DATE: July 26 2023

PERMIT NUMBER: P007641
The Association of Professional Engineers and Geoscientists of Alberta (APEGA)

PERMIT: _____ ENGINEER: _____

APPROVED: _____ DRAWN: _____ DATE: 2023-04-11

MANAGER OF ENGINEERING: _____ SCALE: AS SHOWN

TOWN OF CANMORE:

9											
8											
7											
6											
5											
4											
3	2023	07	24	ISSUED FOR TENDER		JA	JW	JG			
2	2023	07	07	ISSUED FOR TOWN APPROVAL		JA	JW	JG			
1	2023	06	02	ISSUED FOR TOWN APPROVAL		AI	JW	JG			
REV	YYYY	MM	DD	DESCRIPTION	DPS	CHK	ENG				

CONSULTANT: WSP Canada Inc. CONSULTANT FILE NUMBER: 231-01538-00

Town of Canmore ENGINEERING SERVICES
CAP 7301

TYPICAL DETAILS

SHEET NO: C1000 TOWN FILE NO: -

