

NOT FOR CONSTRUCTION



**McElhanney**

McElhanney Ltd.

#203, 502 Bow Valley Trail  
 CANMORE AB, T1W 1N9  
 PH (403) 800-3992  
 www.mcelhanney.com

COORDINATE SYSTEM: **UTM**  
 GROUND: **AS SHOWN**  
 ALL DIMENSIONS ARE METRES  
 UNLESS OTHERWISE NOTED

LOCATION KEY



THE CONSULTANT HAS BEEN ADVISED BY THE CLIENT THAT THE CLIENT IS RESPONSIBLE FOR THE ACCURACY OF THE INFORMATION PROVIDED TO THE CONSULTANT. THE CONSULTANT HAS CONDUCTED VISUAL VERIFICATION OF THE INFORMATION PROVIDED TO THE CONSULTANT. THE CONSULTANT HAS CONDUCTED VISUAL VERIFICATION OF THE INFORMATION PROVIDED TO THE CONSULTANT. THE CONSULTANT HAS CONDUCTED VISUAL VERIFICATION OF THE INFORMATION PROVIDED TO THE CONSULTANT.

PERMIT TO PRACTICE  
 McELHANNEY LTD.  
 REGISTRATION NO. 22282  
 PERMIT NUMBER: P006383  
 The Department of Municipal Affairs and Culture

PERMIT:

ENGINEER:

REV	D	M	Y	DESCRIPTION	DPS	CHK	ENG
01	19	11	24	ISSUED FOR RFP PRICING	KB	OK	DL

CONSULTANT: McELHANNEY LTD.  
 CONSULTANT FILE NUMBER: 2531-12578

DRWNS: MC  
 DATE: 2023 01 01  
 SCALE:  
 APPROVED:

TOWN ENGINEER:

Town of Canmore  
 ENGINEERING SERVICES

TOWN OF CANMORE  
 CAP 7359 RAILWAY AVE CENTRAL  
 SURFACEWORKS - GEOMETRY  
 SHEET 1 OF 6

SHEET NO: 2531-12578-C-120

TOWN FILE NO: CAP 7359

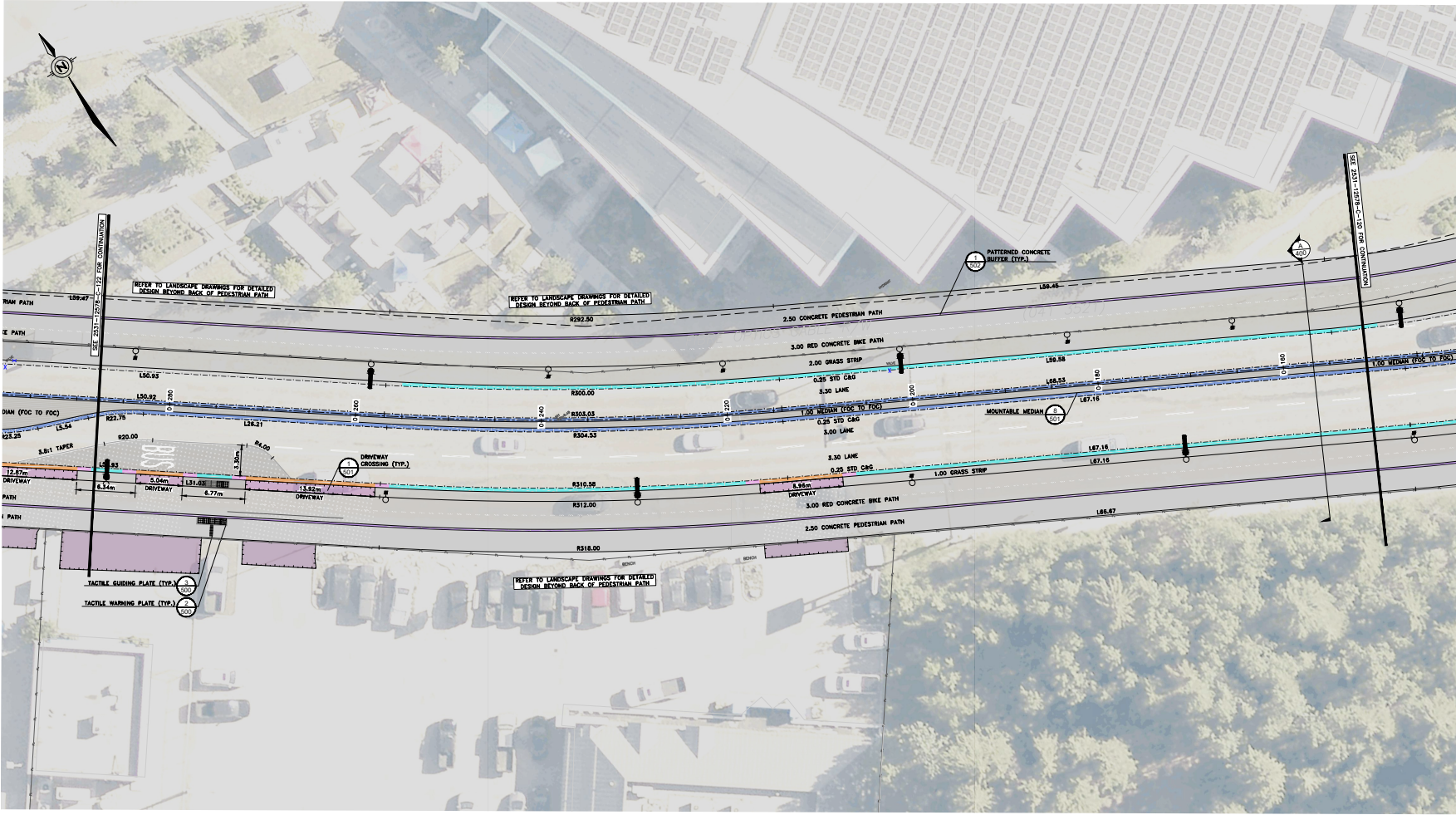

NOT FOR CONSTRUCTION

**McElhanney Ltd.**  
 #203, 502 Bow Valley Trail  
 CANMORE AB, T1W 1N9  
 PH (403) 800-3992  
 www.mcelhanney.com

GROUND ROUND  
 COORDINATE SYSTEM NAD83  
 ALL DIMENSIONS ARE METRES UNLESS OTHERWISE NOTED



THE CONSULTANT SHALL BE RESPONSIBLE FOR THE MONITORING OF UNAUTHORIZED CHANGES TO THIS PLAN. THE CLIENT SHALL BE RESPONSIBLE FOR THE MONITORING OF UNAUTHORIZED CHANGES TO THIS PLAN. THE CONSULTANT SHALL BE RESPONSIBLE FOR THE MONITORING OF UNAUTHORIZED CHANGES TO THIS PLAN.

PERMIT TO PRACTICE  
 MCGILVERAY LTD.  
 PERMIT NUMBER: P006383  
 CONSULTANT FILE NUMBER: 2531-12578-C-121

PERMIT: \_\_\_\_\_ ENGINEER: \_\_\_\_\_

REV	D	M	Y	DESCRIPTION	DPS	CHK	ENG.
01	19	11	24	ISSUED FOR RFP PRICING	KB	OK	DL

DRWNS: WC DATE: 2023 01 01  
 SCALE: \_\_\_\_\_  
 APPROVED: \_\_\_\_\_

Town of Canmore  
 ENGINEERING SERVICES  
 TOWN OF CANMORE  
 CAP 7359 RAILWAY AVE CENTRAL  
 SURFACEWORKS - GEOMETRY  
 SHEET 2 OF 6

SHEET NO: 2531-12578-C-121 TOWN FILE NO: CAP 7359

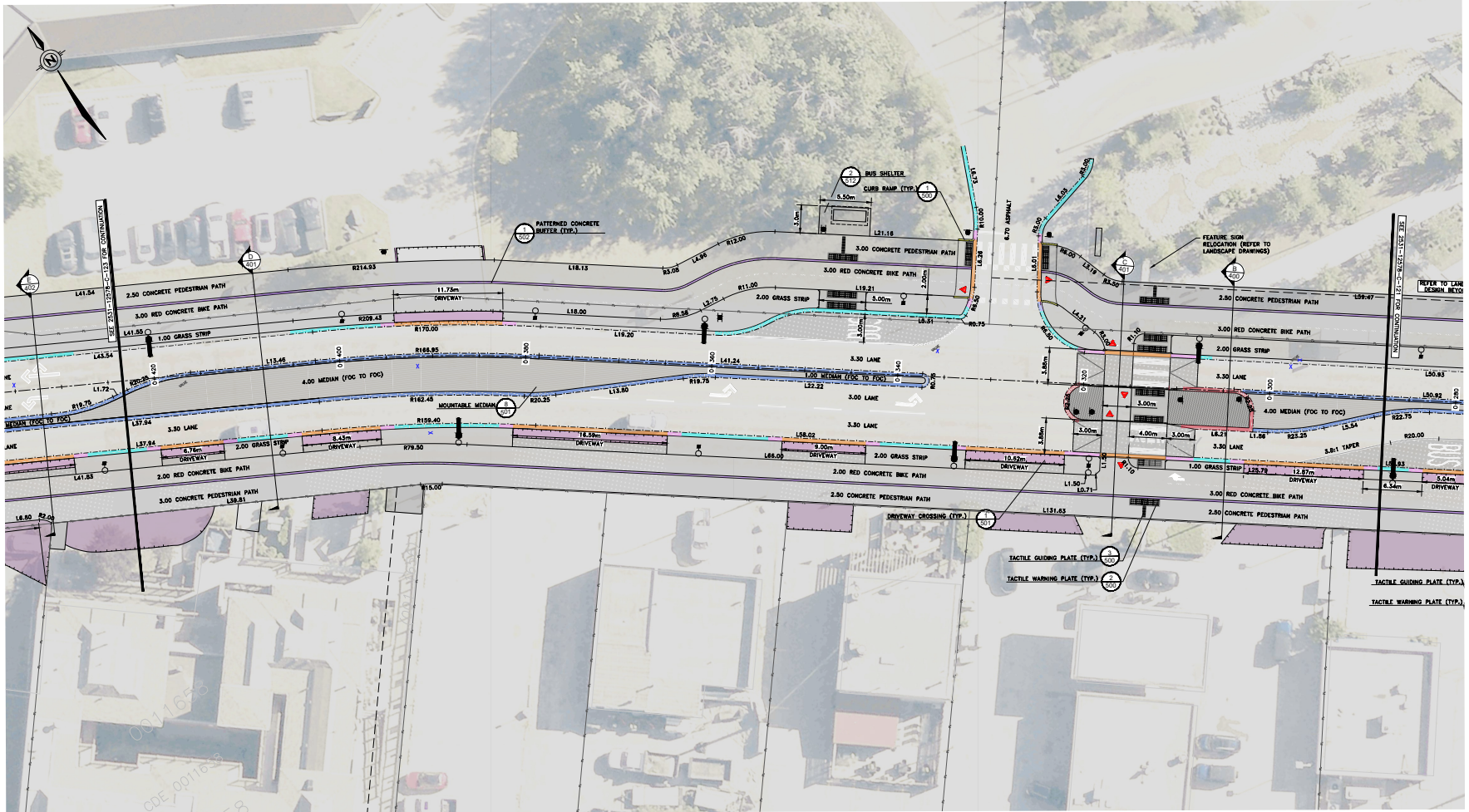

NOT FOR CONSTRUCTION



**McElhanney**

McElhanney Ltd.

#203, 502 Bow Valley Trail  
 CANMORE AB, T1W 1Y9  
 PH (403) 800-3992  
 www.mcelhanney.com

GROUND ROUND   
 COORDINATE SYSTEM METRIC   
 ALL DIMENSIONS ARE METRES  
 UNLESS OTHERWISE NOTED

LOCATION KEY



THE CONSULTANT HAS BEEN ADVISED BY THE CLIENT THAT THE CLIENT IS NOT RESPONSIBLE FOR THE IMPROVED OR UNAUTHORIZED USE OF THIS PLAN. THE CONSULTANT SHALL NOT BE RESPONSIBLE FOR THE IMPROVED OR UNAUTHORIZED USE OF THIS PLAN. THE CONSULTANT SHALL NOT BE RESPONSIBLE FOR THE IMPROVED OR UNAUTHORIZED USE OF THIS PLAN.

PERMIT: \_\_\_\_\_ ENGINEER: \_\_\_\_\_

PERMIT TO PRACTICE  
 McELHANNNEY LTD.  
 REGISTRATION NO. 22282  
 PERMIT NUMBER: P006383  
 The number of previous permits held by this consultant is 0.

REV	D	M	Y	DESCRIPTION	DPS	CHK	ENG.
01	19	11	24	ISSUED FOR RFP PRICING	KB	OK	DL

DRWNS: WC DATE: 2023 01 01  
 SCALE: \_\_\_\_\_  
 APPROVED: \_\_\_\_\_  
 TOWN ENGINEER: \_\_\_\_\_

**Town of Canmore**  
 ENGINEERING SERVICES  
**TOWN OF CANMORE**  
 CAP 7359 RAILWAY AVE CENTRAL  
 SURFACEWORKS - GEOMETRY  
 SHEET 3 OF 6

SHEET NO: 2531-12578-C-122 TOWN FILE NO: CAP 7359

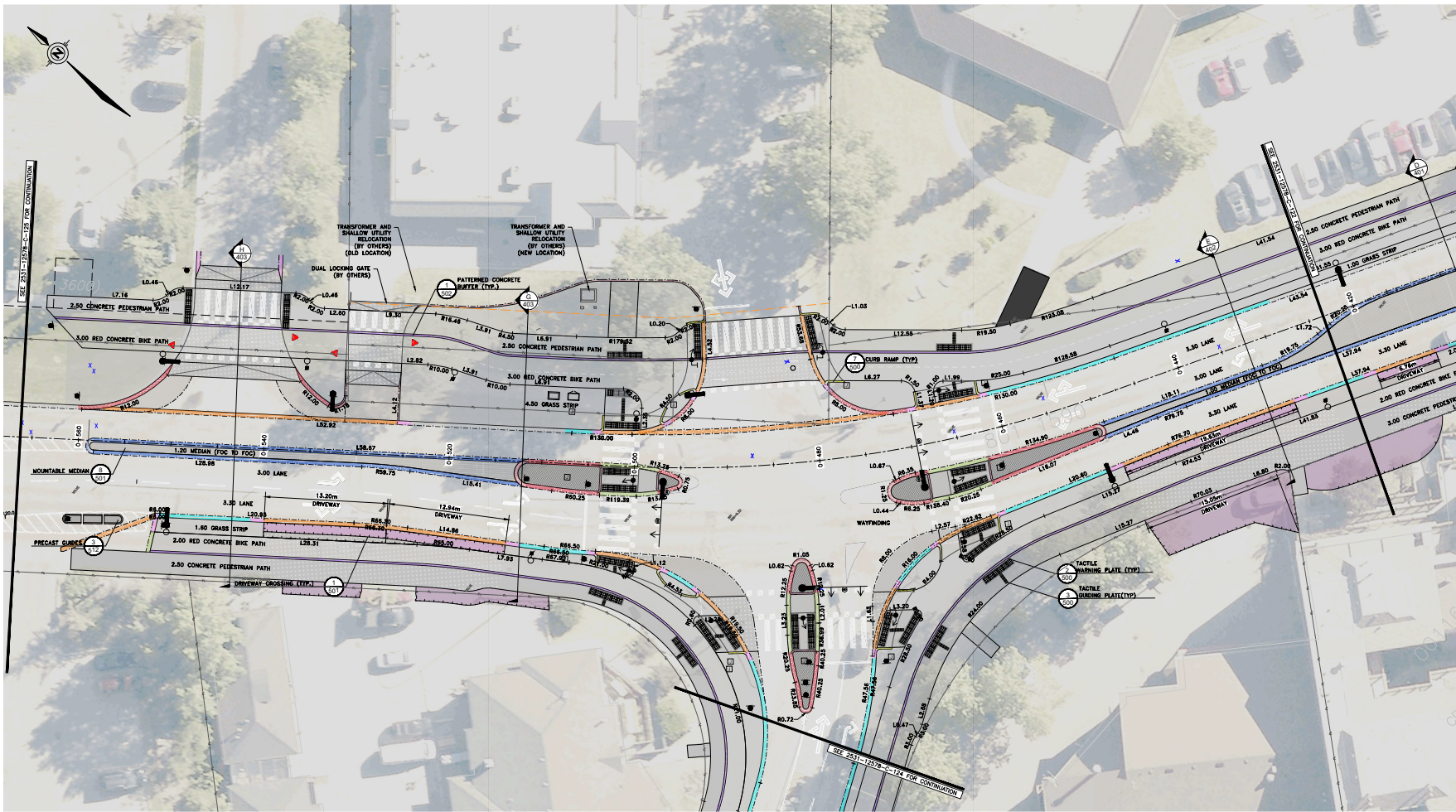

NOT FOR CONSTRUCTION



**McElhanney**

McElhanney Ltd.

#203, 502 Bow Valley Trail  
 CANMORE AB, T1W 1W9  
 PH (403) 800-3992  
 www.mcelhanney.com

GROUND  
 COORDINATE SYSTEM: **NAD 83**  
 ALL DIMENSIONS ARE METRES  
 UNLESS OTHERWISE NOTED

LOCATION KEY



THE CONSULTANT HAS BEEN ADVISED BY THE CLIENT THAT THE CLIENT IS RESPONSIBLE FOR THE ACCURACY OF THE INFORMATION PROVIDED TO THE CONSULTANT. THE CONSULTANT HAS CONDUCTED VISUAL VERIFICATION OF THE INFORMATION PROVIDED TO THE CONSULTANT. THE CONSULTANT HAS CONDUCTED VISUAL VERIFICATION OF THE INFORMATION PROVIDED TO THE CONSULTANT. THE CONSULTANT HAS CONDUCTED VISUAL VERIFICATION OF THE INFORMATION PROVIDED TO THE CONSULTANT.

PERMIT TO PRACTICE  
 McELHANEY LTD.  
 REGISTRATION NO. 22152  
 PERMIT NUMBER: P006383  
 The Association of Professional Engineers and Geoscientists of Alberta

PERMIT:  
 ENGINEER:

REV	D	M	Y	DESCRIPTION	DPS	CHK	ENG
01	19	11	24	ISSUED FOR RFP PRICING	KB	OK	DL

DRWNS: MC DATE: 2023 01 01  
 SCALE: 1:1000  
 APPROVED:

Town of Canmore  
 ENGINEERING SERVICES  
 TOWN OF CANMORE  
 CAP 7359 RAILWAY AVE CENTRAL  
 SURFACEWORKS - GEOMETRY  
 SHEET 4 OF 6

SHEET NO: 2531-12578-C-123 TOWN FILE NO: CAP 7359

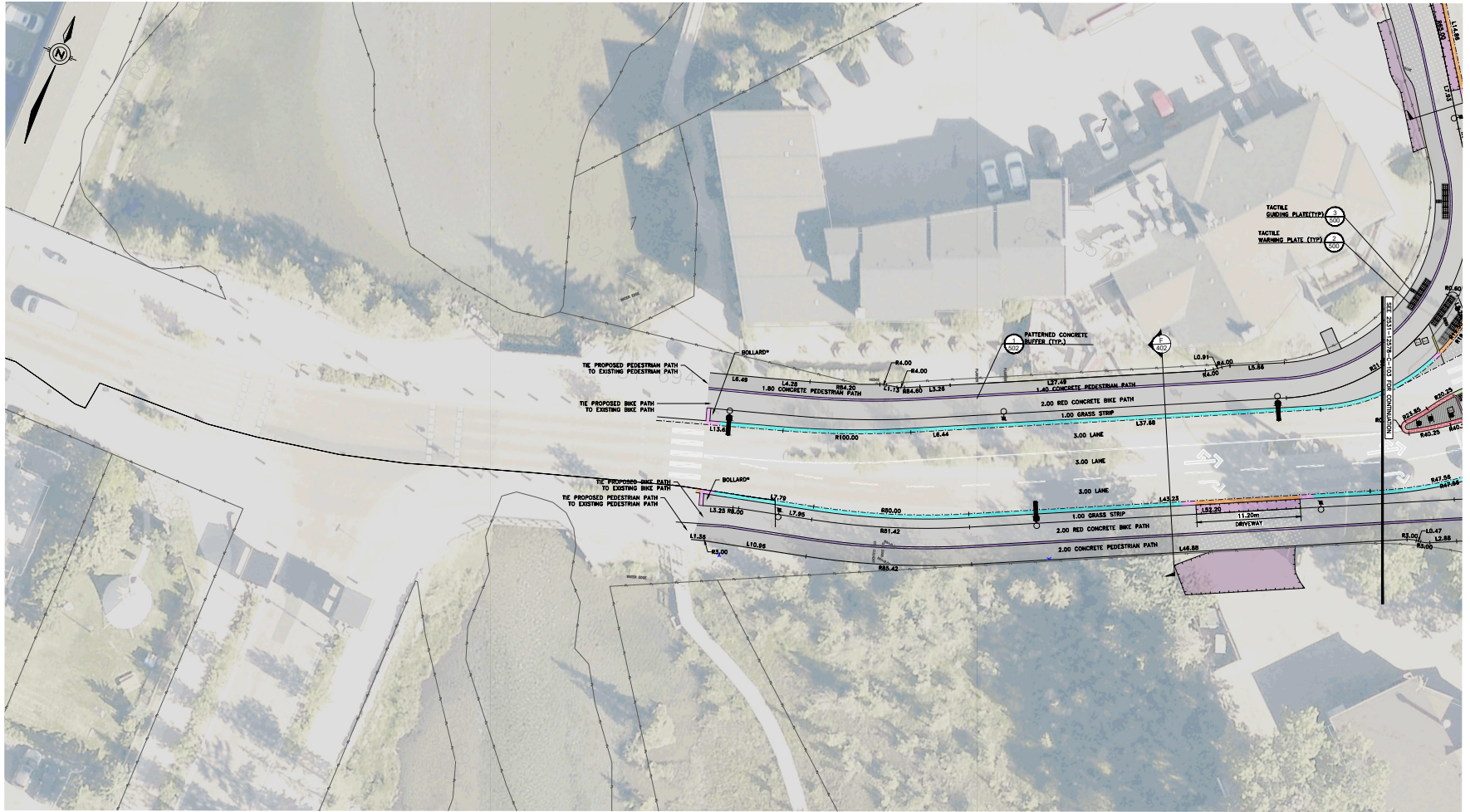

NOT FOR CONSTRUCTION

**McElhanney**  
 McElhanney Ltd.  
 #203, 502 Bow Valley Trail  
 CANMORE AB, T1W 1N9  
 PH (403) 809-3992  
 www.mcelhanney.com

GROUND PROPOSED  
 COORDINATE SYSTEM NORTH  
 ALL DIMENSIONS ARE METRES  
 UNLESS OTHERWISE NOTED

LOCATION KEY



THE CONSULTANT HAS REVIEWED THE RECORD DRAWINGS FOR CONFORMANCE WITH THE PERMIT TO PRACTICE ACT AND REGULATIONS. THE CONSULTANT IS NOT RESPONSIBLE FOR THE ACCURACY OR UNAUTHORIZED USE OF THE INFORMATION CONTAINED HEREIN. THE CONSULTANT HAS REVIEWED THE RECORD DRAWINGS FOR CONFORMANCE WITH THE PERMIT TO PRACTICE ACT AND REGULATIONS. THE CONSULTANT IS NOT RESPONSIBLE FOR THE ACCURACY OR UNAUTHORIZED USE OF THE INFORMATION CONTAINED HEREIN.

PERMIT TO PRACTICE  
 McELHANNEY LTD.  
 REGISTRATION NO. 200603  
 PERMIT NUMBER: P006033  
 The Association of Professional Engineers and Geoscientists of Alberta

PERMIT: \_\_\_\_\_ ENGINEER: \_\_\_\_\_

REV	D	M	Y	DESCRIPTION	DPS	CHK	ENG
01	19	11	24	ISSUED FOR RFP PRICING	KB	OK	DL

DRWNS: MC DATE: 2023 01 01  
 SCALE: \_\_\_\_\_  
 APPROVED: \_\_\_\_\_

Town of Canmore  
 ENGINEERING SERVICES  
 TOWN OF CANMORE  
 CAP 7359 RAILWAY AVE CENTRAL  
 SURFACEWORKS - GEOMETRY  
 SHEET 5 OF 6  
 SHEET NO: 2531-12578-C-124 TOWN FILE NO: CAP 7359



NOT FOR CONSTRUCTION



**McElhanney**

McElhanney Ltd.

#203, 502 Bow Valley Trail  
 CANMORE AB, T1W 1N9  
 PH (403) 800-3992  
 www.mcelhanney.com

GROUND ROUND   
 COORDINATE SYSTEM   
 ALL DIMENSIONS ARE METRES  
 UNLESS OTHERWISE NOTED

LOCATION KEY



THE CONSULTANT SHALL BE RESPONSIBLE FOR THE ACCURACY OF UNAUTHORIZED INFORMATION. THE CONSULTANT SHALL NOT BE RESPONSIBLE FOR THE IMPROPER OR UNAUTHORIZED USE OF THIS DRAWING. THE CONSULTANT SHALL NOT BE RESPONSIBLE FOR THE CONSTRUCTION OF THIS DRAWING. THE CONSULTANT SHALL NOT BE RESPONSIBLE FOR THE CONSTRUCTION OF THIS DRAWING. THE CONSULTANT SHALL NOT BE RESPONSIBLE FOR THE CONSTRUCTION OF THIS DRAWING.

PERMIT TO PRACTICE  
 MCELHANEY LTD.  
 PERMIT NUMBER: P006383  
 PERMIT NUMBER: P006383

PERMIT:  
 ENGINEER:

REV	D	M	Y	DESCRIPTION	DPS	CHK	ENG.
01	19	11	24	ISSUED FOR RFP PRICING	KB	OK	DL

CONSULTANT: MCELHANEY LTD. CONSULTANT FILE NUMBER: 2531-12578

DRAWN: MC DATE: 2023 01 01  
 SCALE:   
 APPROVED:

Town of Canmore  
 ENGINEERING SERVICES  
 TOWN OF CANMORE  
 CAP 7359 RAILWAY AVE CENTRAL  
 SURFACEWORKS - GEOMETRY  
 SHEET 6 OF 6  
 SHEET NO: 2531-12578-C-125 TOWN FILE NO: CAP 7359